

Heddon SPINNING REELS

Quality Ocean and Heavy-Duty
Freshwater Models

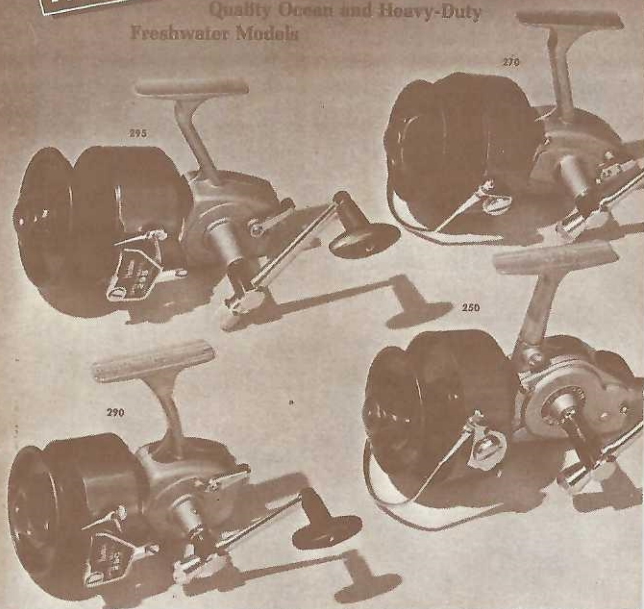

INSTRUCTION & PARTS BOOKLET

FOR HEDDON SPINNING AND

Nos. 120 & 150 SPIN CASTING REELS

JAMES HEDDON'S SONS • DOWAGIAC, MICHIGAN 49047

COMPLETE REEL BOOKLET

Heddon announces 19 great NEW SPIN CASTING and SPINNING REELS

Check the Superb HEDDON
Features Found in These New Reels



TURN-AROUND OR
REVERSIBLE HANDLE*



CORROSION RESISTANT
PARTS. ANODIZED SPOOLS



SUPER-STRENGTH METAL
"SYNCHRO-MATED" GEARS



NEW "POWER GRIP"
DISC DRAG



BALL BEARING
GEAR SYSTEM



AMAZING SPIN/MATIC
LINE RELEASE AND PICK-UP

**HEDDON QUALITY • TESTED and
PROVED • SUPERBLY DESIGNED**



HEDDON 120 SPIN CASTING REEL

- * Sturdy All-metal Construction
- * New "Power-Grip" Drag
- * Silent Anti-reverse
- * Rugged Metal Gears



HEDDON 150 SPIN CASTING REEL

- * Anti-reverse ON-OFF Knob
- * Corrosion Resistant Throughout
- * Rugged Metal Gears
- * Strong All-metal Construction

RIGHT WAY TO USE YOUR SPIN/MATIC SPINNING REEL

1



Pick up line with right index finger.

2



Following through in one continuous motion from #1, depress Spin/matic pin as shown.

3



Raise rod over shoulder to approximately 15° position (just past a straight up-down position).

4

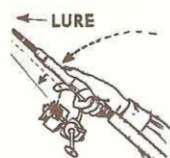

To cast, bring rod forward with a snap motion. When rod is about 15° forward position, release index finger and lure will shoot forward freely.

5



Use crank to retrieve line. **DO NOT CRANK AGAINST A FISH OR A SNAG!** Work the fish with your rod toward you with a pumping motion.

6

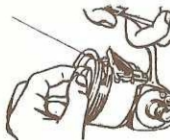

To set drag, move drag knob clockwise for tension, counter clockwise to loosen drag. **REMEMBER**, always s-l-o-w-l-y so as not to break your line.

RIGHT WAY TO USE YOUR HEDDON OPEN FACE REEL



1

Pick up line with index finger.



2

While holding line with index finger, push bail open with other hand until it clicks into position.



3

Raise rod over right shoulder to approximately a "one o'clock" position (just past a straight up-down position).

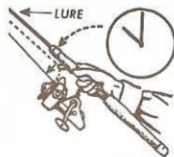

4

"Cast" by bringing rod forward with a "snap" motion. When rod is at "ten o'clock" position, release index finger and the lure will carry line to target.



5

Retrieve line by cranking as shown. DO NOT CRANK AGAINST A FISH OR A SNAG! Work the fish with your rod, "pumping" the fish toward you.



6

Pre-set your drag (brake) to tension less than breaking point of line or leader. ONLY IF NECESSARY to save endangered line, slow a "running" fish by tightening drag SLIGHTLY. Don't apply tension too quickly as fish may break the line.

RIGHT WAY TO USE YOUR HEDDON SPIN CASTING REEL



1

To release, depress thumb lever and hold. Line is now released for cast but is held by thumb's depressing of lever.



2

Raise rod to 15° position over right shoulder. Continue to hold lever depressed with thumb.



3

To "cast", bring rod forward with a snap to about 15° forward position as shown. The instant rod tip is in this position, RELEASE THUMB and the lure will shoot forward freely.



4

Retrieve by cranking as shown. DO NOT CRANK AGAINST A FISH OR A SNAG! Work the fish with your rod, "pumping" the fish toward you.



5

Pre-set your "drag" (brake) to tension LESS than breaking point of line or leader. ONLY IF NECESSARY to save endangered line, slow "running" fish by tightening drag SLIGHTLY. Don't apply tension too quickly as fish may break line.

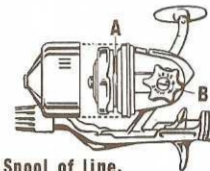

6

A—Spool of line.

B—Drag Knob provides more or less line tension. It should be set in "light" to "intermediate" range.

RIGHT WAY TO USE YOUR HEDDON OCEAN SPINNING REEL

1

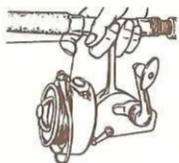

Pick up line with index finger.

2



While holding line with index finger, push bail open with other hand until it clicks into position.

3

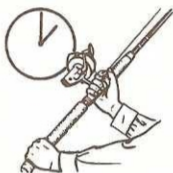

Raise rod over right shoulder to approximately a "one o'clock" position (just past a straight up-down position).

4

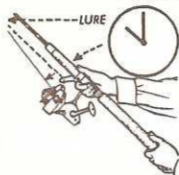

"Cast" by bringing rod forward with a "snap" motion. When rod is at "ten o'clock" position, release index finger and the lure will carry line to target.

5



Retrieve line by cranking as shown. DO NOT CRANK AGAINST A FISH OR A SNAG! Work the fish with your rod, "pumping" the fish toward you.

6



Pre-set your drag (brake) to tension less than breaking point of line or leader. ONLY IF NECESSARY to save endangered line, slow a "running" fish by tightening drag SLIGHTLY. Don't apply tension too quickly as fish may break the line.

Heddon

PRE-WOUND SPOOLS

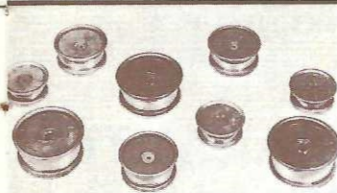

PRE-WOUND SPOOLS

EVERY FISHERMAN SHOULD HAVE AT LEAST ONE EXTRA PRE-WOUND SPOOL IN HIS FISHING KIT. HEDDON OFFERS PRE-WOUND SPOOLS ON ALL MODELS OF THEIR OPEN AND CLOSED FACE SPINNING REELS.

FACTORY-FILLED SPOOLS AVAILABLE IN FOLLOWING YARDAGES OF LINE WEIGHTS

Heddon Reel Model Number	Price of Spool Purchased By Itself Without Line	Price of Factory-Filled Spool of Heddon Deluxe Fishing Line (price is that of line alone; spool is FREE)	Spool Filled With Yardage in Following Amounts of Heddon Deluxe Fishing Line								
			2#	4#	6#	8#	10#	12#	15#	20#	25#
295	\$3.95	\$8.75	--	--	--	--	--	350	300	250	225
290	3.50	6.25	--	--	--	300	275	250	225	--	--
280	2.75	5.00	--	275	250	225	180	150	--	--	--
270 R or L	3.95	8.75	--	--	--	--	--	350	300	250	225
260 R or L	3.50	6.25	--	--	--	--	275	250	225	175	--
250	3.75	6.50	--	--	--	--	--	275	250	200	150
205 R or L *	3.50	5.00	--	--	250	225	200	175	--	--	--
210 R or L	3.50	6.25	--	--	--	--	275	250	200	175	--
245 *	3.50	5.00	--	--	250	225	200	175	--	--	--
235 *	3.50	4.00	250	225	200	175	150	--	--	--	--
230	1.50	5.00	--	--	250	225	200	175	--	--	--
220 R or L	1.50	5.00	--	--	250	225	200	175	--	--	--
120	1.25	4.00	--	--	200	175	150	--	--	--	--
150	1.50	4.50	--	--	--	200	175	150	--	--	--

* INCLUDES ENTIRE SNAP-ON SPOOL ASSEMBLY.

NOTE: In some cases, a soft cotton backing has been used to bring spools to proper casting height. Line yardages are minimum...you will receive slightly more than yardages listed.

EACH HEDDON REEL IS BACKED BY HEDDON'S FAMOUS GUARANTEE

The Heddon Guarantee

The Heddon name on any product assures you of the finest tackle that can be produced. Designed by seasoned fishermen, engineered and produced by skilled craftsmen, it stands apart for sheer perfection.

Every item of Heddon tackle is built to give absolute satisfaction and is guaranteed as far as quality of materials and workmanship are concerned.

FOR FAMOUS HEDDON SERVICE —

For promptest service, avoid rush periods when possible (April through July) and follow these steps:

1. Pack reels carefully.
2. Insure to protect against loss or damage in mails.
3. Identify shipment by printing full name and address inside AND outside of package.
4. Send letter telling us package is on way and describing reel problem.
5. Include copy of letter in package (if possible) and identify letter by using same name and address as on package.

SHIP REEL TO:

SERVICE DEPARTMENT
JAMES HEDDON'S SONS
DOWAGIAC, MICHIGAN 49047

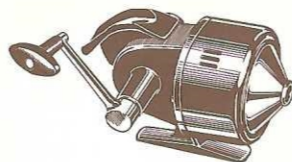

Heddon
120

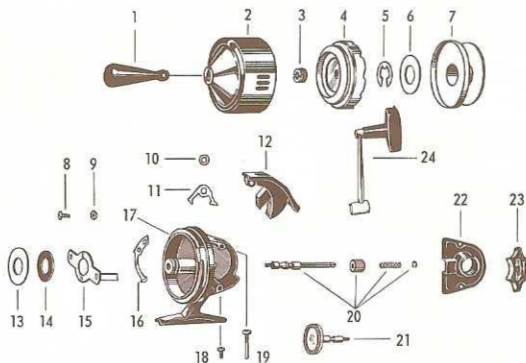

Part No.	Price	Part No.	Price
H 1. Practice Plug	\$.35	H 13. Drag Washer	\$.10
H 2. Front Cover	1.15	H 14. Drag Washer	.10
H 3. Rotor Nut	.25	H 15. Drag Spring	.25
H 4. Rotor	1.50	H 16. Drag Click	.25
H 5. Spool Lock	.20	H 17. Body	1.75
H 6. Spool Washer	.10	H 18. Side Cover Screw	.10
H 7. Spool	1.25	H 19. Side Cover & Push Button Screw	.10
H 8) Click Nut & Bolt	.10	H 20. Pinion Gear Assembly	1.00
H 9) Anti-Reverse Dog Washer	.10	H 21. Drive Gear	.75
H 11. Anti-Reverse Dog	.25	H 22. Side Cover Plate	.50
H 12. Push Button	.35	H 23. Drag Knob	.50
		H 24. Handle Complete	1.00

Heddon

150

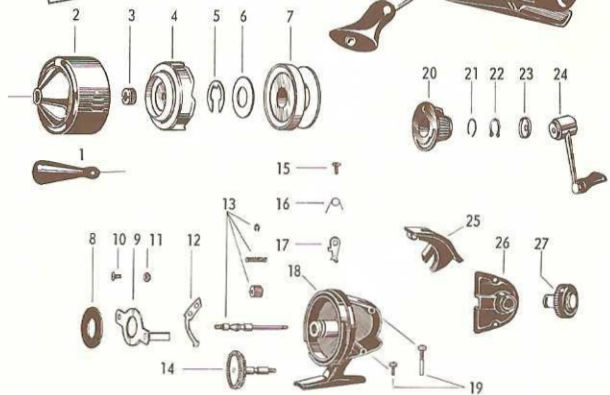

Part No.	Price	Part No.	Price
H 1. Practice Plug	\$.35	H 15) Anti Reverse Screw	\$.40
H 2. Front Cover (Rotor)	1.75	H 16) Spring & Dog	
H 3. Rotor Nut	.15	H 17)	
H 4. Rotor	1.50	H 18. Main Housing	3.50
H 5. Spool Lock Nut	.10	H 19. Body Screws	.15
H 6. Spool Washer	.10	H 20. Anti Reverse Lever	.35
H 7. Spool	1.50	H 21. Anti Reverse Lever Spring	.20
H 8. Drag Washer	.15	H 22. Anti Reverse Lock	.25
H 9. Drag Spring	.35	H 23. Anti Reverse Cover	.25
H 10) Drag Spring Screw & Nut	.15	H 24. Handle Complete	1.50
H 11)		H 25. Push Button	.75
H 12. Spool Click	.25	H 26. Side Cover	.75
H 13. Main Gear Pinion Ass'y	1.50	H 27. Drag Knob	.65
H 14. Main Gear	1.25		



Heddon

295

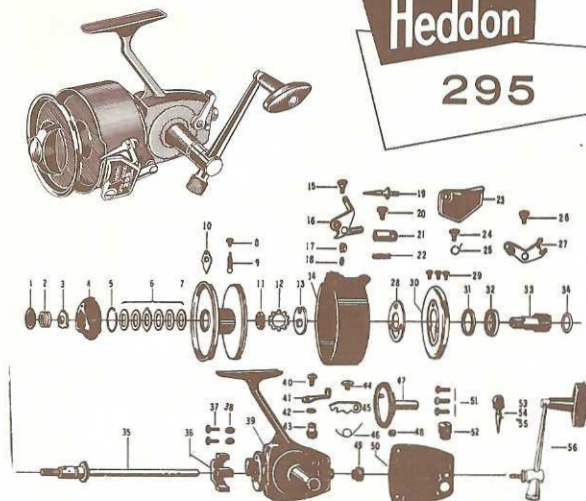

Part No.	Price	Part No.	Price
H 1-4. Drag Adjusting Knob	\$ 1.25	H 32. Ball bearing	\$ 2.45
H 5-10. Spool (sold as com. unit)	3.95	H 33. Pinion Gear and Shaft	2.75
H 11. Spool Cap Nut	0.20	H 34. Shaft Washer	0.10
H 12. Spring Washer	0.15	H 35. Shaft	1.00
H 13. Spool Cap Washer	0.15	H 36. Slide	0.50
H 14. Spool Cap	2.75	H 37. Slide Set Screws	Set 0.25
H 15. Gyro Hinge Screw #1	0.50	H 38. Slide Screw - Lk. Wsh.	Set 0.10
H 16. Gyro Trip Mechanism	1.50	H 39. Main Housing	4.50
H 17. Gyro Nut	0.30	H 40. Anti-reverse Screw	0.10
H 18. Lock Washer	0.10	H 41. Anti-reverse Lever	0.20
H 19. Gyro Pick-up Pin	1.00	H 42. Anti-reverse Washer	0.10
H 20. Gyro Screw #2	0.40	H 43. Anti-reverse Shaft	0.30
H 21. Return Cam	0.75	H 44. Anti-reverse Dog Screw	0.20
H 22. Return Spring	0.35	H 45. Anti-reverse Dog	0.25
H 23. Gyro Pin Release	0.85	H 46. Anti-reverse Dog Spring	0.20
H 24. Gyro Screw #3	0.40	H 47. Main Gear	3.00
H 25. Gyro Spring	0.15	H 48. Main Gear Bushing	0.20
H 26. Gyro Screw #4	0.50	H 49. Lubrication Cap	0.35
H 27. Gyro Yoke	1.00	H 50. Side Plate	1.00
H 28. Anti-Inertia Plate	1.25	H 51. Side Plate Screw	Set of 3 0.25
H 29. Bearing Cover Screw	Set 0.15	H 52. Gyro Pick-up Cover	0.55
H 30. Bearing Cover	1.00	H 53-55. Gyro Pick-up Unit	1.35
H 31. Ball Bearing Race	0.25	H 56. Handle, Complete	2.75

Heddon

290

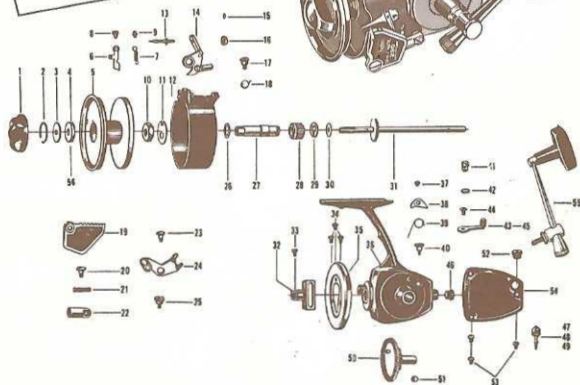

PART NO.	PART	PRICE	PART NO.	PART	PRICE
H 1	Drag Adjusting Knob	.35	H 32	Slide Guide	1.00
H 2-9	Spool (Sold as complete unit)	2.75	H 33	Slide Guide Screws	.05@
H 10	Pinion Nut	.15	H 34	Bearing Cover Screw	.15
H 11	Spool Cap Washer	.25	H 35	Bearing Cover	.75
H 12	Spool Cap	2.50	H 36	Main Housing Unit	3.75
H 13	Gyro Pick-Up (pin)	1.00	H 37	Housing Screw	.15
H 14	Gyro Trip Mechanism	1.50	H 38	Anti Reverse Dog	.25
H 15	Lock Washer	.05	H 39	Anti Reverse Spring	.10
H 16	Gyro Nut	.30	H 40	Anti Reverse Screw	.20
H 17	Gyro Hinge Screw #1	.50	H 41	Anti Reverse Shaft	.15
H 18	Gyro Spring	.15	H 42	Anti Reverse Washer	.10
H 19	Gyro Pin Release	.85	H 43	Anti Reverse Lever	.40
H 20	Gyro Anchor Screw #2	.40	H 44	Anti Reverse Screw	.10
H 21	Return Spring	.35	H 46	Lube Cap	.55
H 22	Return Cam	.65	H 47	(Sold as Spare Gyro Unit)	1.35
H 23	Gyro Screw #3	.40	H 48		
H 24	Gyro Yoke	1.00	H 49		
H 25	Gyro Screw #4	.50	H 50	Main Gear	1.75
H 26	Pinion Washer	.10	H 51	Main Gear Bushing	.10
H 27	Pinion Gear and Shaft	2.50	H 52	Gyro Pin Cover	.55
H 28			H 53	Side Plate Screws	3 for .25
H 29	Pinion Stop Ring	.10	H 54	Side Plate	.75
H 30	Shaft Washer	.10	H 55	Handle (Complete)	2.50
H 31	Shaft	1.00			

Heddon

250

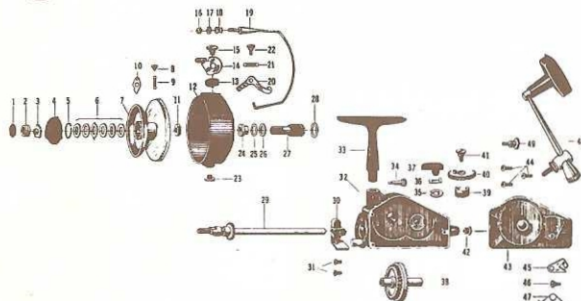
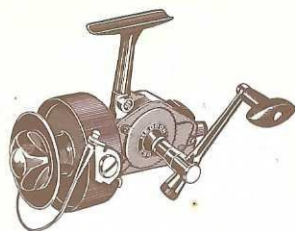

Part No.	Price	Part No.	Price
H 1-4.	Drag Knob, Complete \$ 1.25	H 30.	Slide Guide \$ 0.30
H 5-10.	Spool, Complete 3.75	H 31.	Slide Guide Screw 0.15
H 11.	Spool Cap Nut 0.20	H 32.	Main Housing 3.65
H 12.	Spool Cap 2.25	H 33.	Stand 1.00
H 13.	Bail Spring 0.35	H 34.	Stand Set Screw 0.60
H 14.	Bail Hinge 0.70	H 35.	Stopper Ring 0.10
H 15.	Bail Hinge Screw 0.60	H 36.	Anti-Reverse Spring 0.10
H 16.	Bail Nut 0.20	H 37.	Anti-Reverse Button 0.20
H 17.	Bail Nut Washer 0.10	H 38.	Drive Gear 2.80
H 18.	Line Roller 0.75	H 39.	Crank Pinion 0.60
H 19.	Bail Arm 1.55	H 40.	Crank Gear 1.15
H 20.	Bail Hinge Stopper 0.45	H 41.	Crank Gear Screw 0.30
H 21.	Stopper Spring 0.10	H 42.	Lubrication Cap 0.30
H 22.	Stopper Screw 0.20	H 43.	Housing Cover 1.70
H 23.	Bail Screw 0.20	H 44.	Housing Cover Screw 0.25
H 24.	Spool Bushing 0.40	H 45.	Hook 0.60
H 25.	Pinion Fiber Washer 0.10	H 46.	Hook Screw 0.15
H 26.	Pinion Metal Washer 0.10	H 47.	Hook Spring 0.15
H 27.	Pinion Gear 2.80	H 48.	Crank Handle Complete 3.35
H 28.	Spool Washer 0.10	H 49.	Side Screw 0.45
H 29.	Shaft 1.40		

Heddon

270R/L

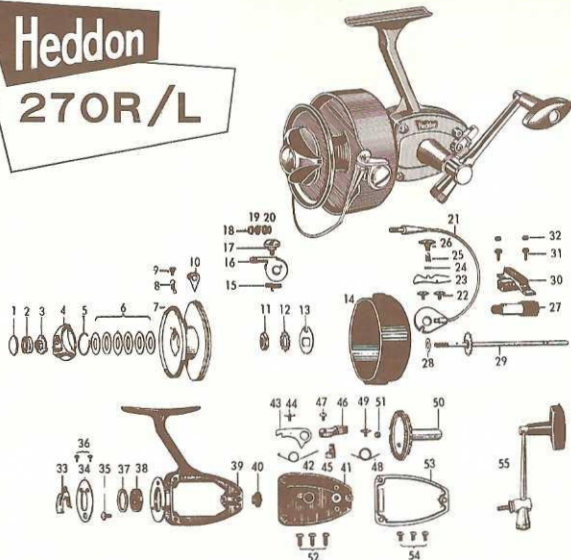

PART #	PART	PRICE
H1-4	Drag Adj. Knob (Comp.)	1.25
H5-10	Spool (Sold as comp. unit)	3.95
H11	Spool Cap Nut	.20
H12	Spring Washer	.15
H13	Spool Cap Washer	.15
H14	Spool Cap	2.00
H15	Bail Spring	.35
H16	Bail Hinge	.70
H17	Bail Hinge Screw	.70
H18	Bail Nut	.10
H19	Bail Washer	.10
H20	Line Roller	.75
H21	Bail Arm	1.65
H22	Stopper Set Screws-2 pcs.	.15
H23	Bail Hinge Stopper	.35
H24	Set Pole	.20
H25	Stopper Spring	.10
H26	Bail Screw	.45
H27	Pinion Gear	2.50
H28	Spool Shaft Washer	.10
H29	Shaft	1.00
H30	Slide Guide	.25
H31	Slide Screws-2 pcs.	.10
H32	Guide Washer	.10

PART #	PART	PRICE
H33	Anti-reverse Brake Spring	.20
H34	Ball Bearing Cover	.10
H35	Bail Tripping Screw	.35
H36	Ball Bearing Cvr. Scrs-2	.10
H37	Ball Bearing Collar	.10
H38	Ball Bearing	3.00
H39	Main Housing	3.50
H40	Lubrication Cap	.35
H41	Housing Cover	1.80
H42	Anti-reverse dog Spring	.20
H43	Anti-reverse Dog	.15
H44	Anti-reverse Dog Screw	.10
H45	Anti-reverse Shaft	.35
H46	Anti-reverse Lever	.15
H47	Anti-reverse Lever Screw	.10
H48	Anti-rev. Lev. Shaft Sp.	.15
H49	Anti-rev. Lev. Shaft Sp. Screw	.10
H50	Drive Gear	2.50
H51	Slide Guide Bushing	.10
H52	Hous. Cover Scrs.-3 pcs.	.20
H53	Side Plate	.65
H54	Side Plate Screws-3 pcs.	.15
H55	Crank Handle, Complete	2.50

Heddon

260R/L

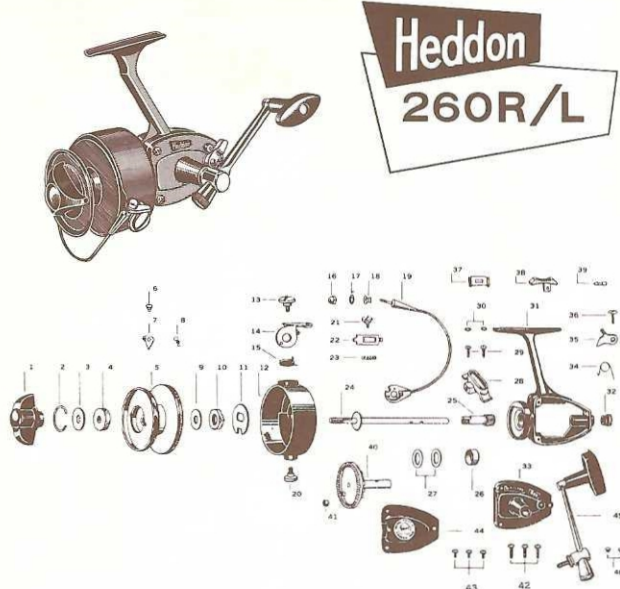

Part No.	Description	Price
H 1.	Drag Nut	\$0.35
H 2-8.	Spool (Sold as Complete Unit)	2.75
H 9.	Spool Free Washer	0.05
H 10.	Pinion Nut	0.20
H 11.	Spool Cap Washer	0.15
H 12.	Spool Cap	1.50
H 13.	Hinge Screw	0.70
H 14.	Hinge	0.70
H 15.	Bail Spring	0.35
H 16.	Bail Nut	0.20
H 17.	Bail Washer	0.10
H 18.	Line Roller	0.35
H 19.	Bail Arm	1.65
H 20.	Bail Screw	0.45
H 21.	Stopper Screw	0.15
H 22.	Bail Hinge Stopper	0.35

Part No.	Description	Price
H 23.	Bail Stopper Spring	\$0.10
H 24.	Spool Shaft	0.75
H 25.	Pinion Gear	2.00
H 26.	Pinion Collar	0.15
H 27.	Collar Washer	0.15
H 28.	Slide Guide	0.25
H 29.	Slide Screws (2 Pcs.)	0.10
H 30.	Guide Washer	0.10
H 31.	Main Housing	3.00
H 32.	Lubrication Cap	0.35
H 33.	Housing Cover	1.40
H 34.	Anti-Reverse Dog Spring	0.20
H 35.	Anti-Reverse Dog	0.15
H 36.	Anti-Reverse Dog Screw	0.10

Part No.	Description	Price
H 37.	Anti-Reverse Shaft	\$0.10
H 38.	Anti-Reverse Lever	0.50
H 39.	Anti-Reverse Spring	0.10
H 40.	Drive Gear	1.50
H 41.	Screw Slide Guide Bushing	0.10
H 42.	Housing Cover Screws (3 Pcs.)	0.20
H 43.	Slide Plate	0.15
H 44.	Side Plate	0.50
H 45.	Crank Handle, Complete	3.00
H 46.	Red Cap 2 Pcs.	0.05

Heddon

210R/L

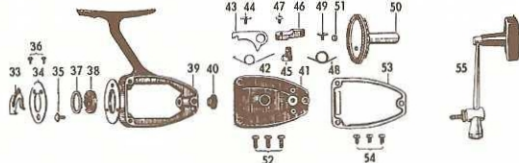
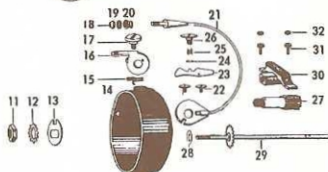
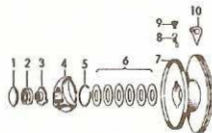
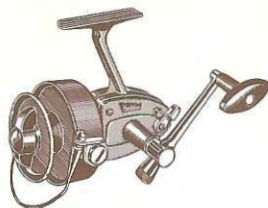

PART#	PART	PRICE
H 1-4	Drag Adj. Knob	1.25
H 5-10	Spool (Sold as comp. unit)	3.50
H 11	Spool Cap Nut	.20
H 12	Spring Washer	.15
H 13	Spool Cap Washer	.15
H 14	Spool Cap	2.00
H 15	Bail Spring	.35
H 16	Bail Hinge	.70
H 17	Bail Hinge Screw	.70
H 18	Bail Nut	.20
H 19	Bail Washer	.10
H 20	Line Roller	.75
H 21	Bail Arm	1.65
H 22	Stopper Set Screws-2 pcs.	.15
H 23	Bail Hinge Stopper	.35
H 24	Set Pole	.10
H 25	Stopper Spring	.10
H 26	Bail Screw	.45
H 27	Pinion Gear	2.50
H 28	Spool Shaft Washer	.10
H 29	Shaft	1.00
H 30	Slide Guide	.25
H 31	Slide Screws-2 pcs.	.10
H 32	Guide Washer	.10

PART#	PART	PRICE
H 33	Anti-reverse Brake Spring	.20
H 34	Ball Bearing Cover	.10
H 35	Bail Tripping Screw	.35
H 36	Ball Bearing Cvr. Sers.-2	.10
H 37	Ball Bearing Collar	.10
H 38	Ball Bearing	3.00
H 39	Main Housing	3.50
H 40	Lubrication Cap	.35
H 41	Housing Cover	1.80
H 42	Anti-reverse dog Spring	.20
H 43	Anti-reverse Dog	.15
H 44	Anti-reverse Dog Screw	.10
H 45	Anti-reverse Shaft	.35
H 46	Anti-reverse Lever	.15
H 47	Anti-reverse Lever Screw	.10
H 48	Anti-rev. Lev. Shaft Sp.	.15
H 49	Anti-rev. Lev. Shaft Sp. Screw	.10
H 50	Drive Gear	2.50
H 51	Slide Guide Bushing	.10
H 52	Hous. Cover Sers.-3 pcs.	.20
H 53	Side Plate	.65
H 54	Side Plate Screws-3 pcs.	.15
H 55	Crank Handle, Complete	2.50

Heddon

245

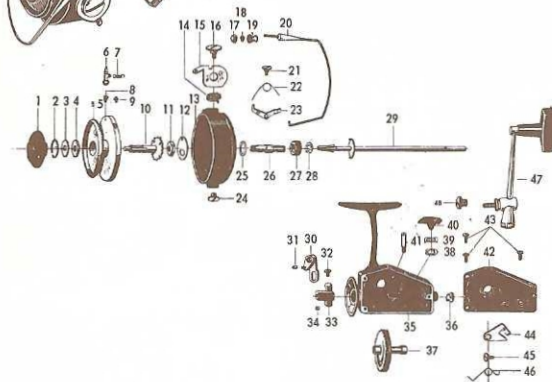
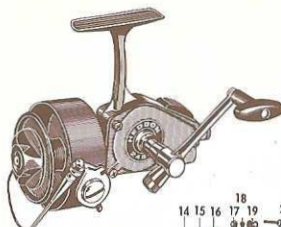

Part No.	Price
H 1. Drag Adjusting Knob.	\$ 0.35
H 1-10. Spool (Sold as complete unit)	3.50
H 11. Pinion Nut	0.15
H 12. Spool Cap Washer	0.10
H 13. Spool Cap	1.40
H 14. Bail Spring	0.25
H 15. Bail Hinge	0.40
H 16. Bail Hinge Screw	0.40
H 17. Bail Nut	0.10
H 18. Bail Nut Washer	0.05
H 19. Line Roller	0.25
H 20. Bail Arm	0.65
H 21. Stopper Spring Bolt	0.15
H 22. Stopper Spring	0.05
H 23. Bail Hinge Stopper	0.20
H 24. Bail Screw	0.15
H 25. Pinion Metal Washer	0.05
H 26. Spool Cap Metal	0.55
H 27. Pinion Gear	0.25
H 28. Pinion Stopper Ring	0.10

Part No.	Price
H 29. Shaft	\$ 0.50
H 30. Come Arm	0.15
H 31. Come Arm Collar	0.05
H 32. Slide Guide Screw	0.05
H 33. Slide Guide	0.15
H 34. Slide Guide Collar	0.05
H 35. Main Housing	2.15
H 36. Lubrication Cap	0.35
H 37. Drive Gear	1.30
H 38. Stopper Washer	0.10
H 39. Anti-Reverse Spring	0.10
H 40. Anti-Reverse Button	0.20
H 41. Come Arm Shaft	0.10
H 42. Side Plate	1.00
H 43. Side Plate Screws	0.20
H 44. Hook	0.30
H 45. Hook Screws	0.15
H 46. Hook Spring	0.10
H 47. Crank Handle Complete	1.80
H 48. Side Plate Screw	0.40

Heddon

230

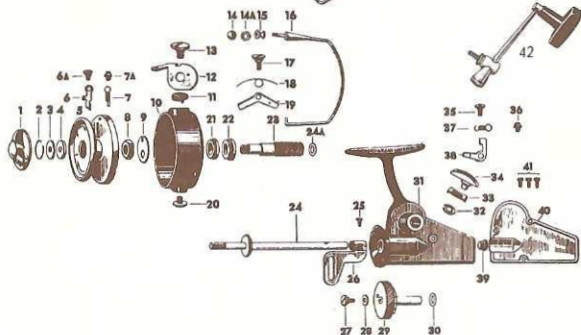
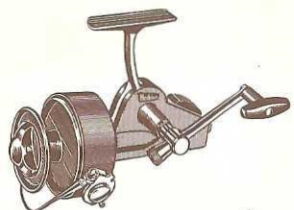

Part No.	Price	Part No.	Price
H 1. Drag Adjusting Knob	\$ 0.35	H 24A. Fiber Washer	\$ 0.05
H 2-7A. Spool (Sold as complete unit)	1.50	H 25. Crank Arm Screw	0.05
H 8. Pinion Nut	0.15	H 26. Crank Arm	0.45
H 9. Spool Cap Washer	0.10	H 27. Crank Screw	0.15
H 10. Spool Cap	1.40	H 28. Crank Washer	0.35
H 11. Bail Spring	0.25	H 29. Drive Gear	2.15
H 12. Bail Hinge	0.40	H 30. Drive Gear Washer	0.35
H 13. Bail Hinge Screw	0.40	H 31. Main Housing	2.15
H 14. Bail Nut	0.10	H 32. Stopper Washer	0.10
H 14A. Bail Washer	0.05	H 33. Anti-Reverse Spring	0.10
H 15. Line Roller	0.25	H 34. Anti-Reverse Button	0.20
H 16. Bail Arm	0.65	H 35. Anti-Reverse Dog Screw	0.15
H 17. Stopper Spring Bolt	0.15	H 36. Anti-Reverse Spring Set Screw	0.10
H 18. Stopper Spring	0.05	H 37. Anti-Reverse Spring	0.05
H 19. Bail Hinge Stopper	0.20	H 38. Anti-Reverse Dog	0.25
H 20. Bail Screw	0.15	H 39. Lubrication Cap	0.35
H 21. Thrust Ball Bearing	0.40	H 40. Side Plate	0.55
H 22. Thrust Ball Bearing	0.40	H 41. Side Plate Screws	0.15
H 23. Pinion Gear	2.45	H 42. Crank Handle, Complete	1.50
H 24. Shaft	0.50		

Heddon

280

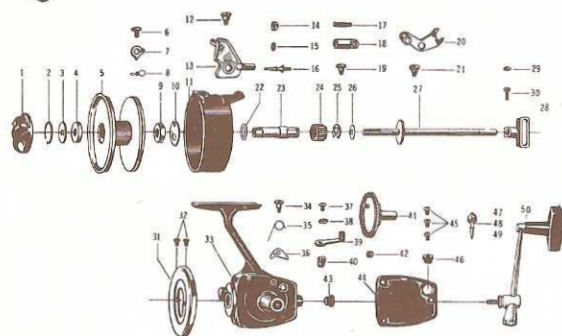

PARTS	PART	PRICE	PARTS	PART	PRICE
H 1	Drag Adjusting Knob	.35	H 29	Slide Guide Washer	.10
H 2-8	Spool (sold as comp. unit)	2.50	H 30	Slide Guide Screw	.15
H 9	Pinion Nut	.15	H 31	Bearing Cover	.75
H 10	Spool Cap Washer	.25	H 32	Bearing Cover Screws-Set	.15
H 11	Spool Cap	2.50	H 33	Main Housing	3.50
H 12	Gyro Hinge Screw #1	.50	H 34	Anti-Reverse Screw	.15
H 13	Gyro Trip Mechanism	1.50	H 35	Anti-Reverse Spring	.10
H 14	Gyro Nut	.30	H 36	Anti-Reverse Dog	.25
H 15	Lock Washer	.05	H 37	Housing Screw	.15
H 16	Gyro Pick-up Pin	1.00	H 38	Anti-Reverse Washer	.10
H 17	Return Spring	.35	H 39	Anti-Reverse Lever	.50
H 18	Return Cam	.65	H 40	Anti-Reverse Shaft	.15
H 19	Gyro Anchor Screw #2	.50	H 41	Main Gear	1.50
H 20	Gyro Yoke	1.00	H 42	Main Gear Bushing	.10
H 21	Gyro Screw #4	.50	H 43	Lube Cap	.50
H 22	Pinion Washer	.10	H 44	Side Plate	.75
H 23	Pinion Shaft	1.00	H 45	Side Plate Screws-3 for ..	.25
H 24	Pinion Gear	1.50	H 46	Gyro Pick-up Cover	.50
H 25	Pinion Stop Ring	.10	H 47		
H 26	Shaft Washer	.10	H 48	Spare Gyro	1.35
H 27	Shaft	1.00		(Sold as Complete Unit)	
H 28	Slide Guide	1.00	H 50	Handle (Complete)	2.25

Heddon

205R/L

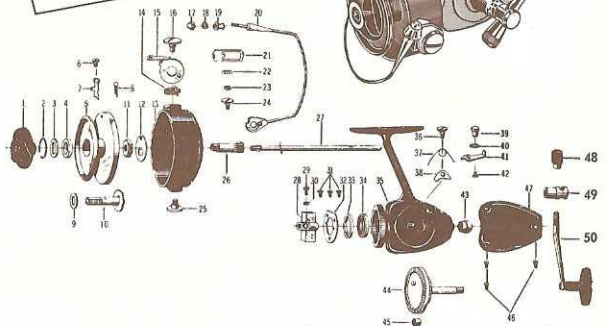

Part No.	Price	Part No.	Price
H1. to 10. Sold as 1 Unit - Spool Complete	\$ 3.75	H29. Slide Screw	\$ 0.10
H11. Pinion Nut	0.25	H30. Slide Washer	0.10
H12. Spool Cap Washer	0.25	H31. Ball Bearing Cover Screws Set of 3	0.25
H13. Spool Cap	2.50	H32. Ball Bearing Cover	0.75
H14. Bail Spring	0.35	H33. Ball Bearing Washer	0.35
H15. Bail Hinge	0.75	H34. Ball Bearing	1.75
H16. Bail Hinge Screw	0.65	H35. Main Housing	2.75
H17. Bail Nut	0.20	H36. Anti Reverse Dog Screw	0.15
H18. Bail Washer	0.10	H37. Anti Reverse Dog Spring	0.10
H19. Bail Roller	0.75	H38. Anti Reverse Dog	0.10
H20. Bail	1.75	H39. Anti Reverse Shaft	0.10
H21. Trip Lever	0.45	H40. Anti Reverse Washer	0.10
H22. Trip Lever Spring	0.10	H41. Anti Reverse Lever	0.10
H23. Trip Lever Washer	0.10	H42. Anti Reverse Lever Screw	0.10
H24. Trip Lever Screw	0.35	H43. Lubrication Cap	0.10
H25. Ball Screw No. 2	0.40	H44. Drive Gear	1.50
H26. Pinion Gear	1.50	H45. Slide Bushing	0.10
H27. Main Shaft	0.50	H46. Side Plate Screws Set of 3	0.15
H28. Slide	0.25	H47. Side Plate	0.65
		H48, 49, 50. Sold as 1 Unit	3.00

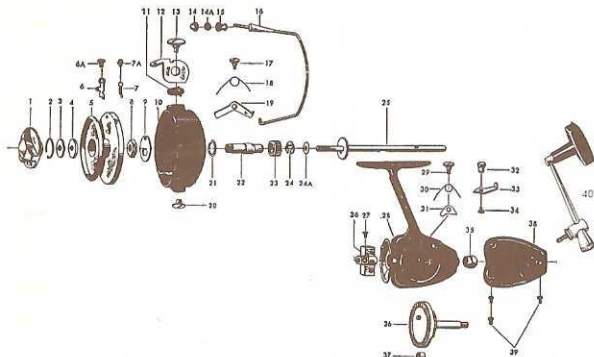

Part No.	Price	Part No.	Price
H1. Drag Adjusting Knob	\$ 0.35	H24. Pinion Stopper Ring	\$ 0.10
H2-7A. Spool (Sold as complete unit)	1.50	H24A. Fiber Washer	0.05
H8. Pinion Nut	0.15	H25. Shaft	0.50
H9. Spool Cap Washer	0.10	H26. Slide Guide	0.15
H10. Spool Cap	1.40	H27. Slide Guide Screw	0.05
H11. Bail Spring	0.25	H28. Main Housing	2.00
H12. Bail Hinge	0.40	H29. Anti-Reverse Dog Screw	0.15
H13. Bail Hinge Screw	0.40	H30. Anti-Reverse Spring	0.05
H14. Bail Nut	0.10	H31. Anti-Reverse Dog	0.05
H14A. Bail Washer	0.05	H32. Anti-Reverse Shaft	0.10
H15. Line Roller	0.25	H33. Anti-Reverse Lever	0.10
H16. Bail Arm	0.65	H34. Anti-Reverse Lever Screw	0.10
H17. Stopper Spring Bolt	0.15	H35. Lubrication Cap	0.05
H18. Stopper Spring	0.05	H36. Drive Gear	0.95
H19. Bail Hinge Stopper	0.20	H37. Slide Guide Bushing	0.05
H20. Bail Screw	0.15	H38. Housing Cover	0.55
H21. Pinion Metal Washer	0.05	H39. Housing Cover Screws	0.15
H22. Spool Cap Metal	0.55	H40. Crank Handle, Complete	1.20
H23. Pinion Gear	0.25		

Heddon

235

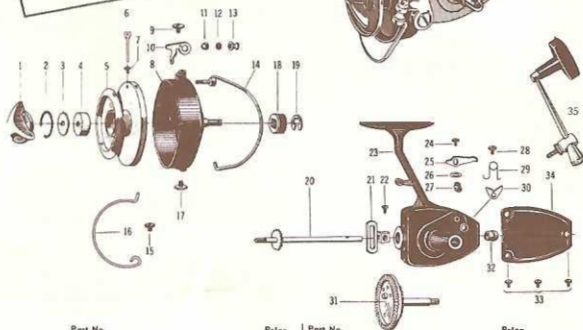

Part No.

Price

Part No.

Price

H 1. Drag Adjusting Knob

\$ 0.25

H 21. Slide

0.25

H 2. to 7. Spool

1.45

H 22. Slide Screw

0.10

H 8. Spool Cap

1.25

H 23. Main Housing

1.25

H 9. Trip Lever Screw

0.40

H 24. Anti Reverse Lever Screw

0.10

H 10. Trip Lever

0.40

H 25. Anti Reverse Lever

0.10

H 11. Bail Nut

0.10

H 26. Anti Reverse Lever Washer

0.30

H 12. Bail Nut Washer

0.05

H 27. Anti Reverse Lever Shaft

0.10

H 13. Bail Roller

0.25

H 28. Anti Reverse Screw

0.10

H 14. Bail

0.50

H 29. Anti Reverse Spring

0.10

H 15. Trip Spring Screw

0.20

H 30. Anti Reverse Dog

0.10

H 16. Trip Spring

0.30

H 31. Main Gear

0.75

H 17. Bail Screw

0.30

H 32. Lubrication Cap

0.05

H 18. Pinion Gear

0.35

H 33. Side Plate Screws

Set of 3 0.15

H 19. Pinion Stopper Ring

0.10

H 34. Side Plate

0.45

H 20. Shaft

0.25

H 35. Handle Complete

0.85

WHAT EVERY FISHERMAN SHOULD HAVE!

HEDDON'S NEW CATALOG

- * 68 Pages in Full Color
- * More Than 700 Items
- * Valuable Fishing Tips and Hints

CLIP OUT COUPON AND ORDER TODAY

TO: JAMES HEDDON'S SONS
DOWAGIAC, MICHIGAN 49047

Please rush to me your latest Giant Deluxe Consumer Catalog. I've inclosed 25¢ (no stamps, please) for catalog, postage and handling.

NAME _____

ADDRESS _____

CITY _____ STATE _____ ZIP _____

Print Clearly • Enclose Money • No Stamps, Please



Only 25¢

250

NEW Heddon

STARCAST RODS

Tubular Fiberglass \$10.95

Solid Fiberglass \$7.95

IMPROVED HANDLES

HEDDON QUALITY

AMAZING VALUE



MATCH A FAMOUS HEDDON ROD TO YOUR NEW REEL

— PRICED FROM \$6.95, SUGGESTED RETAIL —

— MORE THAN 120 MODELS TO MATCH ANY NEED —

JAMES HEDDON'S SONS • DOWAGIAC, MICHIGAN 49047

PART NO. 38000

PRINTED IN U.S.A.