



Quick 330/331

Finessa

SPINNING REEL

Adjustable for Right and Left Hand Retrieving





Quick 330/331

Finessa

Allow us to introduce the Quick 330 Finessa and Quick 331 S Finessa, Fast Speed, members of the famous Quick family produced by the D-A-M. Many thousands of these reels are being used throughout the world by discerning and exacting fisherman.

With these reels you have craftsmanship and precision.

This reel can be used for any kind of fresh water fishing, river or lake, and for saltwater fishing since all parts are non-corrosive. Please note the specific features of Quick 331 S on page 19.

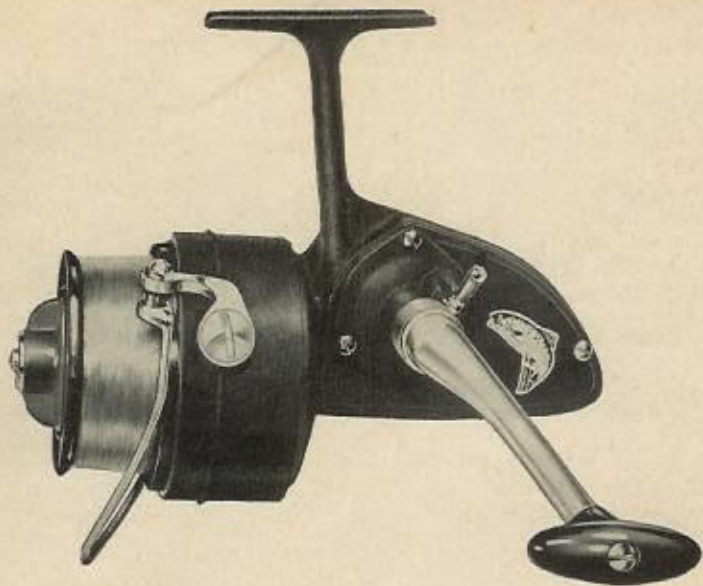

Special features

Please look at the reel closely and you will at once recognize its superiority. Note these features.

1. Built-in worm gear for smooth and almost noiseless operation.
2. Large gear ratio of 1:3.5 for quick retrieve of line.
3. Ball bearing on main shaft for smooth operation and long life.
Oil-less bronze crankshaft bearing.
Positive anti-reverse clutch.
6. Handle easily changed over for right or left hand cranking.
Handle folds down for carrying or storing.
7. Rugged closed full bail pick-up of non-corroding steel with tungsten carbide line guide.
8. Push button spool with brake nut, clock face dial and large line capacity.
9. All parts salt water resistant.
Approx. weight of reel $12\frac{1}{2}$ oz.

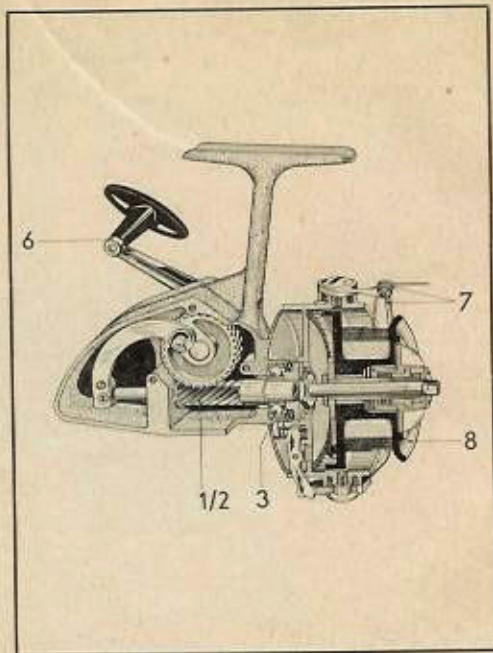

Keep your reel free from dirt and grit at all times.

Lubricating

Every reel is properly oiled and greased at the factory. However, the reel should be oiled after use at the points indicated by the arrows. With moderate use, the reel should be greased at the end of every season. To do this, remove the side plate, clean out the inside of the reel, remove the old grease and re-pack with any good grease obtainable from your tackle store. If the reel is in constant use, it will be advisable to check from time to time instead of waiting until the end of the season.

Sometimes dirt and grit gets into the hole in the handle grip. This can be cleaned out by removing the grip screw which holds the handle grip in place.

Do not lay your reel on soil or sandy ground and avoid rough usage.

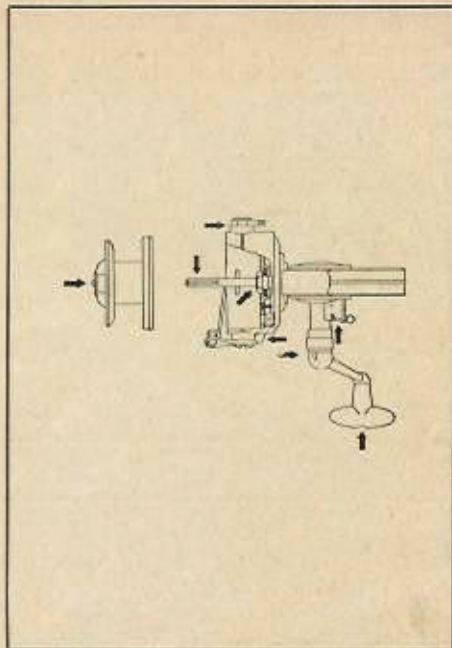

The Line Spool

The reel can be used with a deep or shallow spool. Two cork halves are provided, which when mounted on the spool, convert it from deep to shallow. Using the cork halves, sufficient light line can be wound on the spool for all normal fishing. When using heavier line, the cork halves should be removed. Use the cork halves up to about 8-lb. test line.

Operating the Reversible Handle

The crank arm can be folded down for carrying or storage. The knurled sleeve just under the crank arm can be screwed or unscrewed to loosen the handle for folding or to hold it in a rigid position for cranking. The handle can be moved from one side of the reel to the other to permit cranking with either left or right hand. Instructions will be found in this booklet on page 16.

Line capacity of spools in yards.

Monofilament Line Ø in inches	lbs. test	deep spool (without cork)	spool with cork
.007	4	650	325
.008	6	420	210
.010	8	285	160
.013	12	220	110
.015	15	165	100

Winding the line on the spool.

With empty spool mounted on the reel, place reel on underside of rod grip and swing the pick-up arm over the face of the spool until it is locked. Thread the line through the first guide and fasten line to spool with a tight slip knot. Tighten the brake nut firmly and begin winding the line by turning the handle. The pick-up arm will close automatically, pick up the line and wind it on the spool. Wind continuously, keeping a little tension on the line to ensure even filling. Avoid loose line as it causes trouble. A spool filled to the lip makes the best casts. Only by having the line correctly and tightly distributed can long casts be made.

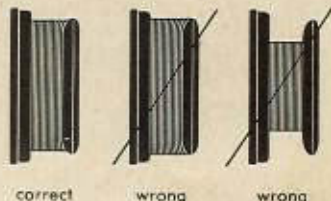

And which line for fishing? We recommend **GOLD DAMYL-Line** – the perfect line for "Quick-Fishing". GOLD DAMYL is unaffected by fresh and saltwater and can therefore be left wet on the reel. GOLD DAMYL is available in the following sizes:

Size (inches)	.005	.007	.008	.010	.011	.013	.015	.017	.018
Breaking strain (lbs)	2	4	6	8	10	12	15	20	25
Size (inches)	.020	.026	.028	.030					
Breaking strain (lbs)	30	40	50	60					

Changing the line spool.

To remove the spool, press the push-button and draw off the spool. To replace, slip on spool, press down and turn clockwise to be sure it is locked firmly. If push button is accidentally depressed it will unlock the spool. If this happens be sure to remove the spool completely, replace and re-lock.

If the line does not go on evenly (if it builds up at the front lip or the rear of the spool), this can easily be corrected by adding or removing washers. These washers are located under the line spool on the brake spindle and are accessible without difficulty by taking off the spool, unscrewing the brake nut and removing the axle (see illustration). If the line tends

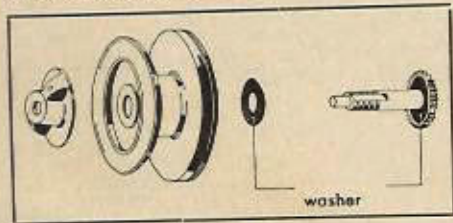

to pile on the front lip on the spool an additional washer can be put on. If the line piles on the rear of the spool a washer should be removed. Extra washers are supplied in the box with every reel.

Adjusting the Brake

The brake or drag is adjusted by turning the brake nut in front of the spool. Tightening or loosening the brake nut gives more or less tension on the line. The brake should be adjusted a little below the breaking strain of the line being used, and this can be best tested in actual practice while fishing. If you start out with the brake fairly loose, you can gradually tighten it as you feel the pull on the line, and your judgment will tell you how far you can go. You can always tell when the brake is in operation by the clicking of the ratchet on the underside of the spool. Naturally, the heavier the line, the tighter the tension should be.

The white dot on the brake nut used in connection with the scale of figures on the spool will help in the adjustment of the brake pressure. After adjusting the brake nut to the particular line you are using,

you can note the position of the white dot in relation to the figures and leave it there. If it is moved by accident, you can put it back in the same place. Since it is not necessary to turn the brake nut in order to remove the spool because of the snap-on type spool used on this reel, it may not be necessary to move the brake nut. However, for different types of fishing, slightly different tension may be required even with the same line.

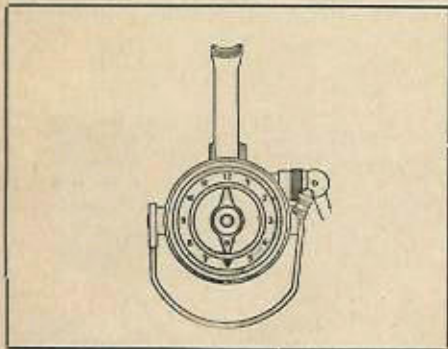

The anti-reverse clutch.

The anti-reverse clutch is mounted on the crank arm housing. It is engaged and disengaged by means of a small ball pin.

When the ball pin is pointing half-way down the anti-reverse is ON.

When it points directly backwards the anti-reverse is OFF.

Note: The two **upward** positions of the anti-reverse ball lever should not be used. However when the handle is transferred to the opposite side they become the **down** positions, and come into use at that time. The anti-reverse clutch is used when fishing. In combination with the brake it provides the tension required for playing the fish. It should also be used when carrying rod and reel with line and bait mounted; in this way line will not pull off accidentally.

A little practice will soon lead to perfect casting with the Quick 330.

Preparing to cast

Mount the reel on rod and take care that the guides are correctly in line. Swing the pick-up arm over the face of the spool until it is locked. Thread the line through the guides and mount the bait on the end of the line. Now operate the handle. The first turn of the handle automatically closes the pick-up arm over the face of the spool and picks up the line, carrying it to the line guide and so on to the spool.

Beginning the cast

Use the Quick 330 Reel downwards only. Hold the rod-grip with the right hand while the stem of the reel is between the third and fourth finger. Now pick up the line with the right forefinger slightly bent, and press the line against the rod with your forefinger. With the other hand swing the pick-up-arm over the face of the spool until it locks in position. The line is now ready for casting. If you use the reel with the handle on the right side, you would of course hold the rod in the left hand.



Overhead casting

Allow the bait to hang a short distance from the rod tip (about 10 inches). Bring rod to a vertical position and take it a little further back over the shoulder. Flick the wrist forward and when the rod tip moves towards the target release the line by straightening the forefinger; the bait will shoot forward towards the target. With very little practice you will soon learn when to release the line. The line can be slowed down or stopped on the target by dropping the forefinger to the lip of the spool or by turning the handle anti-clockwise. The line of course is rewound by operating the handle. It is very important to see that line is correctly and tightly distributed on the spool and a certain amount of pull is needed to produce the necessary tension. Usually the weight of the bait being drawn through the water will provide enough tension to wind the line on the spool evenly (see page 6). All other kinds of casting (side swing and pendulum fashion etc.) can easily be done with a Quick 330.

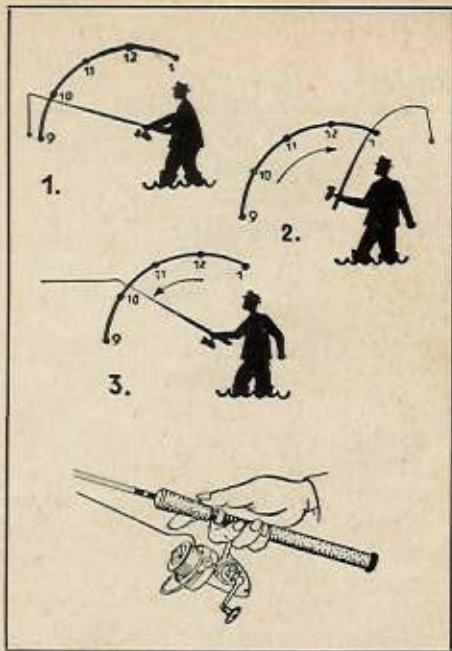

Technical Description of Spare Parts

Part No.	Name of Part	Part No.	Name of Part
1.00 010	Bolt for anti-reverse clutch	1.00 083	Washer
1.00 011	Ball lever	1.00 086	Washer for ratchet wheel
1.00 012	Compression spring	1.00 087	Washer for ratchet wheel
1.00 013	Plastic tubing	1.00 097	Washer 12 x 7
1.00 014	Ratchet	1.00 098	Washer 10 x 4,5
1.00 016	Ratchet spring	1.00 099	Washer
1.00 019	Line guide	1.00 104	Plain disc
1.00 024	Hexagon nut	1.00 107	Plain washer
1.00 038	Pin for screw wheel	1.00 109	Rubber buffer
1.00 045	Pin for crank arm	1.00 112	Cover cap
1.00 051	Handle screw	1.00 132	Bearing bushing for housing
1.00 061	Changing spring	1.00 134	Handle nut
1.00 069	Lock washer	1.00 142	Security ring
1.00 070	Spring ring	1.00 144	Snap ring
1.00 072	Safety spring ring	1.00 145	Ratchet wheel
1.00 073	Washer	1.00 149	Handle grip
1.00 078	Safety ring	1.00 154	Driving axle
1.00 082	Spring ring for ball bearing	1.00 176	Ball bearing

Technical Description of Spare Parts

Part No.	Name of Part	Part No.	Name of Part
1.00 179	Flange bushing	1.00 493	Brake spindle
1.00 184	Crank arm, complete	1.00 495	Cork ring, halved
1.00 185	Crank arm	1.00 496	Spool compl. with brake spindle and brake nut
1.00 435	Screw for slide	1.00 497	Spool compl. without brake nut and brake spindle
1.00 436	Shaft screw	1.00 499	Driving plate
1.00 444	Bearing cover	1.00 500	Washer 15 x 8,1
1.00 447	Screw for bearing cover	1.00 501	Screw wheel, compl.
1.00 463	Stop screw	1.00 515	Plastic box for line spool
1.00 468	Flange, complete	1.00 516	Housing, compl.
1.00 470	Stop lever	1.00 518	Case cover
1.00 472	Bearing pin	1.00 526	Slide
1.00 474	Drag spring	1.00 527	Connecting piece
1.00 475	Angle lever	1.00 528	Axle, compl.
1.00 476	Bearing screw	1.00 530	Plate cover, compl.
1.00 477	Pick-up, compl.	1.01 182	Safety ring
1.00 481	Washer		
1.00 482	Crank nut		
1.00 488	Brake nut, compl.		

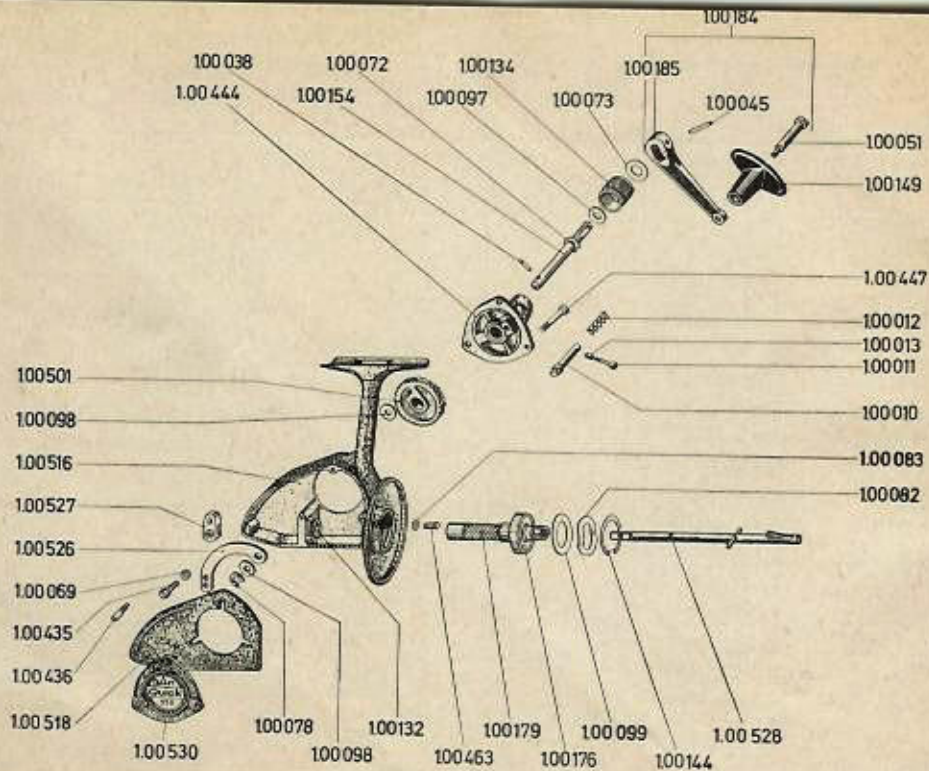

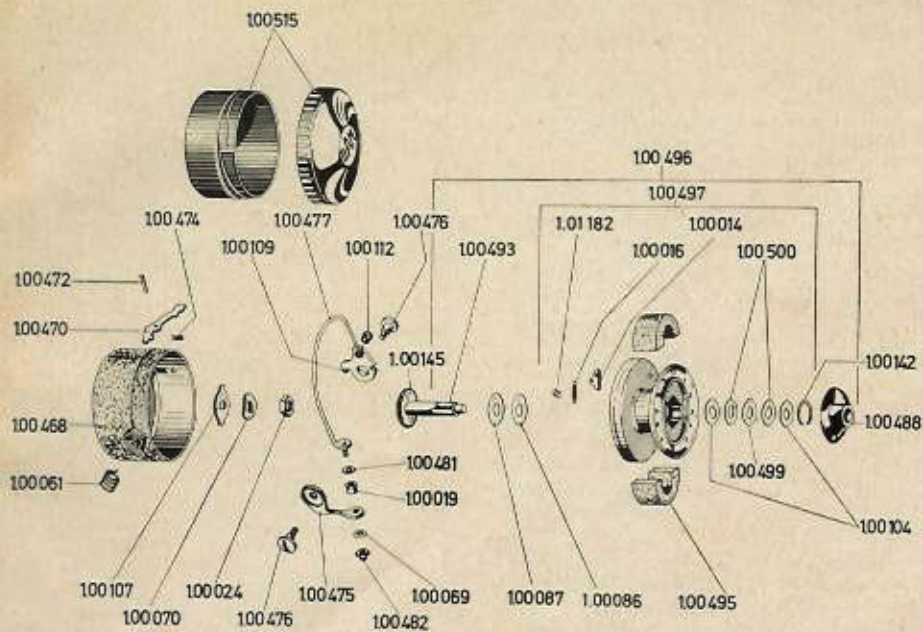

Changing the crank handle from left to right hand

Cranking with the left or right hand is a matter of individual preference. The reel is delivered with the handle mounted in the way it is most commonly used. Follow these instructions to change it.

1. Remove plastic cover 1 and side plate 2 by loosening the four holding screws (Fig. 1), on the right side of reel.
2. Place the tip of the screw driver in the small semicircular slot of the safety spring ring 3. Now push the safety spring ring sideways by using the pin 4 as support for the screwdriver. Remove washer 5 (Fig. 2).
3. Unscrew pin 6 and remove lever arm 7 (Fig. 2).
4. Loosen the 4 holding screws on the left side of the reel and remove complete handle and anti-reverse assembly 8 and side plate 9 (Fig. 3).
5. Place side plate 2 and complete handle and anti-reverse assembly 8 on the other side of housing and fasten the four screws. Make sure that the anti-

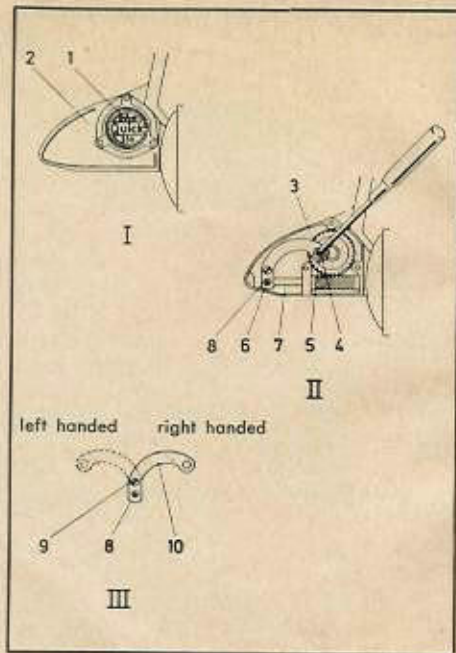

reverse assembly points towards the rear (Fig. 4).

6. Reverse the anti-reverse clutch by pulling out anti-reverse lever slightly, then lift it over the stop nose and place it in the next notch position.
7. Place extra lever arm 10 (Fig. 5) in position over pin 4 (Fig. 6). Then replace washer 5. Now place safety spring ring 3 in position and push it sideways over the grooved pin and give it a final push with the screwdriver to place it properly into position (Fig. 6).
8. Fasten lever arm 10 on axle with screw pin 6 (Fig. 6).
9. Finish the operation by replacing side plate 9 and plastic cover 1 on the open side of the housing and fasten with the 4 screws.

The reel is now ready to be used for right hand cranking.

When changing handle from right to left hand cranking reverse the procedure.

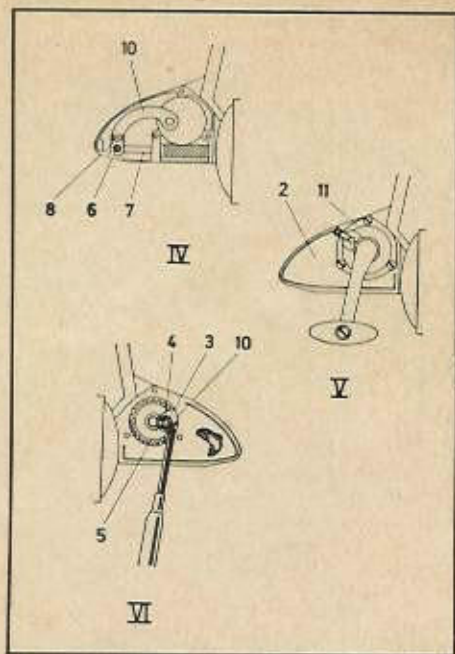

Changing bail pick-up spring

1. Unscrew nut (a) by using flat-nosed pliers, and remove lock washer (b).
2. Free bail (c) from angle lever (d) by turning the latter slightly to the right. Take off line guide (e).
3. Unscrew bearing screw (f) by using a coin, and remove angle lever and old spring (g).
4. When placing new spring in position, put the protruding end of the spring (g/2), through the small hole (L/h) in lug on flange.
5. Replace angle lever (d) and insert pointing end of spring (g/1) in bore hole (L/d). Then fasten tightly with bearing screw (f) using coin.
6. Slip line guide (e) over bail screw (c) and stretch the spring by turning angle lever (d) in a clockwise direction.
7. Put loose end of bail screw (c) through hole in angle lever (d/1), place lock washer (b) in position, and fasten with nut (a).

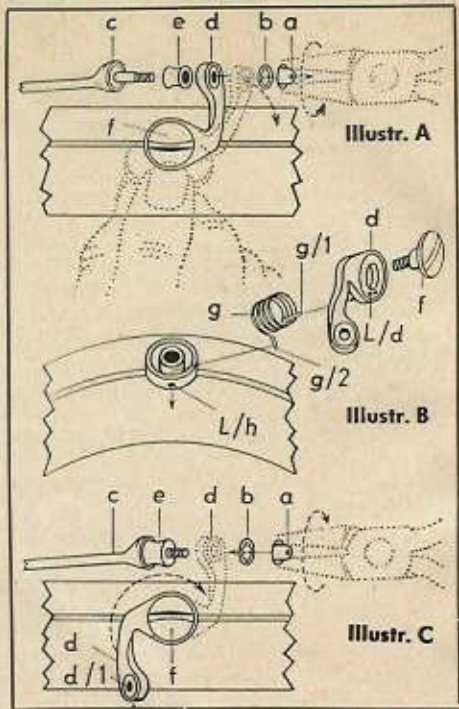

Quick 331

Spinning Reel with fast retrieving gears

This reel is a special Quick 330 Finessa model. It has new special gears with fast retrieve (per rotation 775 mm = 31") and is particularly suited for spinning with the current in fast running waters. Extra long crank arm enables better power transmission.

Please note the following alterations to service instructions as compared to those of the Quick 330 Finessa:

Page 4:	Special features	Item 2	Ratio Quick 331 S: 1 : 4,85
Page 13:	Technical Description of Spare Parts		

Part No. Quick 330	Part No. Quick 331 S	Name of Part
1.00 179	1.00 206	Flange bushing
1.00 184	1.00 208	Crank, compl.
1.00 185	1.00 209	Crank arm
1.00 501	1.00 522	Screw wheel
1.00 530	1.00 521	Plate cover, metal with Type

GUARANTEE

QUICK fishing reels are made from the finest material according to the latest manufacturing methods.

We shall repair or replace free-of-charge any reel damaged due to faulty material or manufacturing providing the reel has been treated carefully and according to the instructions of use.



Quick

Corporation
of America

P.O. Box 938

Costa Mesa, Calif. 92627

Precision-Engineered in West Germany by

