

INSTRUCTION MANUAL

High Technology Electric Reel **KAIGEN1000**

Thank you for buying electric reel of BANAX.

Please be aware of the instructions before use, and we ask you to use it according to the safe and correct method of instructions.

Also please keep this manual with reel because this includes very important details about the reel use.

CONTENTS

1. Attention of safety ----- P2	6. Control box ----- P8	8. Operation method ----- P14~15	* Hi speed mode ----- P20
2. Attention of handling ----- P3~4	7. Preparation before use	* Auto-stop at gunwale ----- P14~15	* Shelf mode ----- P21~22
3. Handling method of reel ----- P5	* Power supply connection method ----- P9	* Setting-up the surface of water ----- P16~17	* Bottom mode ----- P23~24
4. Main function & feature ----- P6	* Fishing line data input method ----- P10~13	* Fishing line release function ----- P18	* Correction of cut PE fishline ----- P25
5. Each part's name & function ----- P7		* Automatic winding & the change of speed ----- P19	9. Safety function ----- P26~27
			10. When fault is doubtful ----- P28
			11. Part list ----- P29~30

ATTENTION OF SAFETY

Please read certainly before use

Warning



- Please take care that the finger would not be got between level wind and main body.

Attention



- Please do not hold the fishline while the line release is fast. You may get your finger cut by fishline.
- Please do not use the reel for the other use except the fishing.
- Stain clothes etc. because grease and gasoline were added for the turning segment of reel. Please take care not to be.



- Please do not touch the revolving parts during the reel operation. You may get the wound.
- Push on/off switch after you check if the stopper's position is "on" or not.



- Do not disassemble / convert the reel. That can be the reason of mechanical trouble.



- Use only the battery, designated voltage. You can get burned from calorification in case that you use others except the designated.



- When the reel is soaked with the water, please do not wash it.

2

Attention of handling

1 Regarding the power supply

Power supply is D.C 12V (exclusive use). It is not available for you to use the others (A.C 110V or 220V for home, D.C24V for ship) except the designated power supply.

- Low volume battery can not show the electric reel's capacity owing to the sudden drop of electric pressure. We advise you to use the battery over 1000mAh.
- Because 12V power supply have a occasion that the voltage is unstable according to the state of wiring or generator, normal performance is impossible because the protection channel of this occasion reel operates or there is occasion that operation is suspended. Please use the exclusive battery only for electric reel.
- Please use fully charged battery.
- Electric current malfunction can happen because of the rust on the reel terminal. If there is the rust on the reel, please, use the reel after cleaning the rust completely.



DC 12V
(1000mAh)



AC110V, 220V



DC24V



Please check below list before leaving



- If you leave the battery alone for a long time, it is possible that natural discharge can lower the battery capacity. Before go fishing, please, charge the battery fully.
- Sometimes, you can not use the voltage of the ship because of the voltage type in the ship. We suggest you to check the voltage before use.

Attention of handling

2 Regarding power supply cord

- When connecting the power supply to the reel, necessarily use the supply cord which is enclosed with the reel in the package box.
If you use the renovated supply cord except the pure components, the reel can malfunction.
- Please, handle the supply cord with care.
The actions like winding, stepping, or bending the supply cord on the reel can be a defect reason.
- After using the reel, clean the contaminated parts with a soft towel which is wet with water and dry and keep it.
(Don't wash under the water.)
- When you pull out the supply cord, pull out the supply cord with seizing the connector.

3 Regarding reel's main body

- In case that the fishing line is caught in an obstacle on the bottom during using the reel, please, do not pull the fishing rod or the reel excessively.
- Please, handle the reel with care in order to prevent from a falling shock.
- When setting up the fishing rod holder on the ship, please, handle with care in order to prevent from a shock of the back of the reel and the supply cord.

3

The method of taking care of the reel

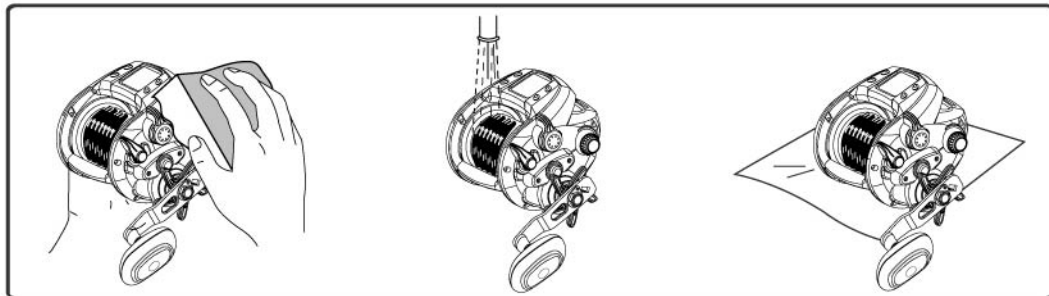

- 1** Please clean the contaminated parts of reel's body with a sponge or towel which is wet with a detergent.
- 2** Remove a detergent and contaminated material by spraying water. Remove also the salt on the spool part by spraying water.
- 3** After removing the moisture, dry it in the shade.



Attention

- Please use a neutral detergent.
- Please do not wash reels under the water.
- In case of leaving the reel alone in a humid place, this can cause modification or quality deterioration. After washing, keep it in the air and high temperature and dry place.
- Never use an oil in the drag part.
This can cause drag power deterioration or trouble.
- Please put on connector cap, when you do not use the reel in order to protect the connector.

Main functions and features

Speed lever	Available to control power ON/OFF and fishline winding speed
Perfect drag	Soft adjustment / Power / Adoption of durable carbon material
Moment move	This function solves the fishline tangle and makes you lure the fish conveniently
Auto stop before the gunwale	This function makes you set up the gunwale stop position depending on the fishing tackle
Hi speed	This function makes you wind the fishline at a max speed. It makes you retrieve the fishing tackle conveniently.
Setting up the surface of water	This function makes you set up the surface of water at "0"m, so you can target the swimming range more correctly.
Release of the fishline	The motor helps the spool rotate, so you can release the fishing tackle to the position you want more quickly.
Setting up the swimming range	When releasing the fishing line, this function makes you alarm based on the memorized position that many fishes exist.
Memory of auto swimming range	This function makes you check and set up the position that many fishes take a bait.
Bottom mode	Displaying the fishing tackle position from the bottom
Correction of cut fishline	This function makes you correct the fishline data when fishline is cut during the fishing

5

Each part's name & function

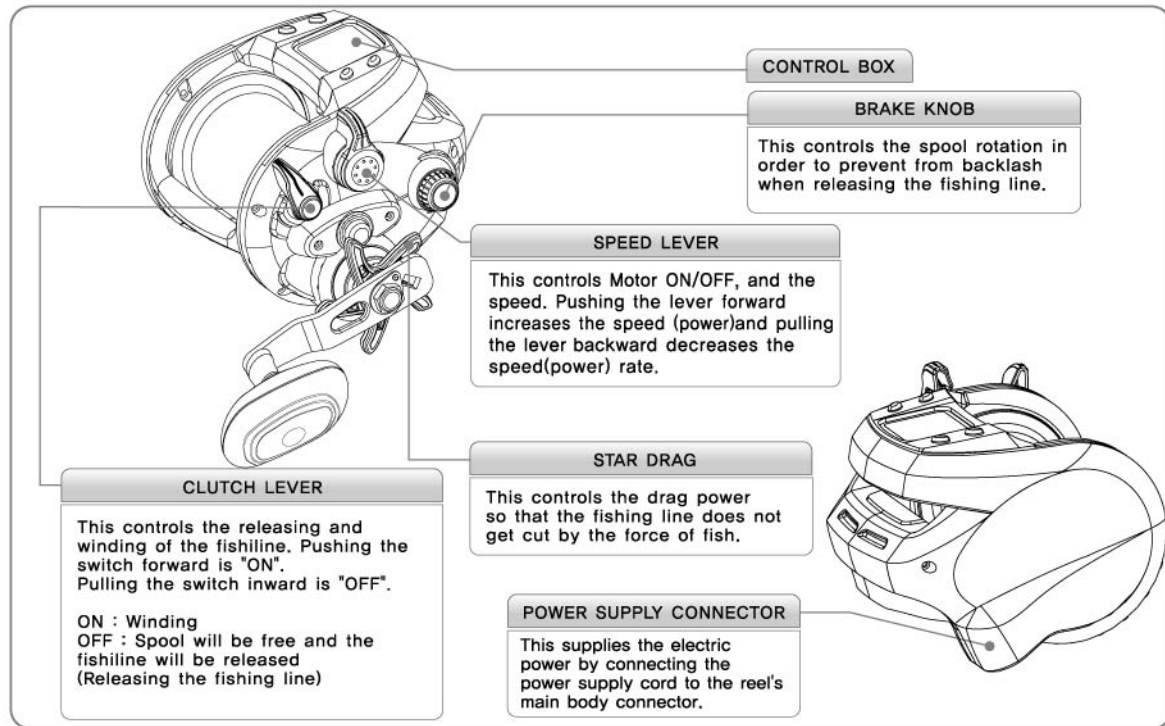

Each part's description of control box

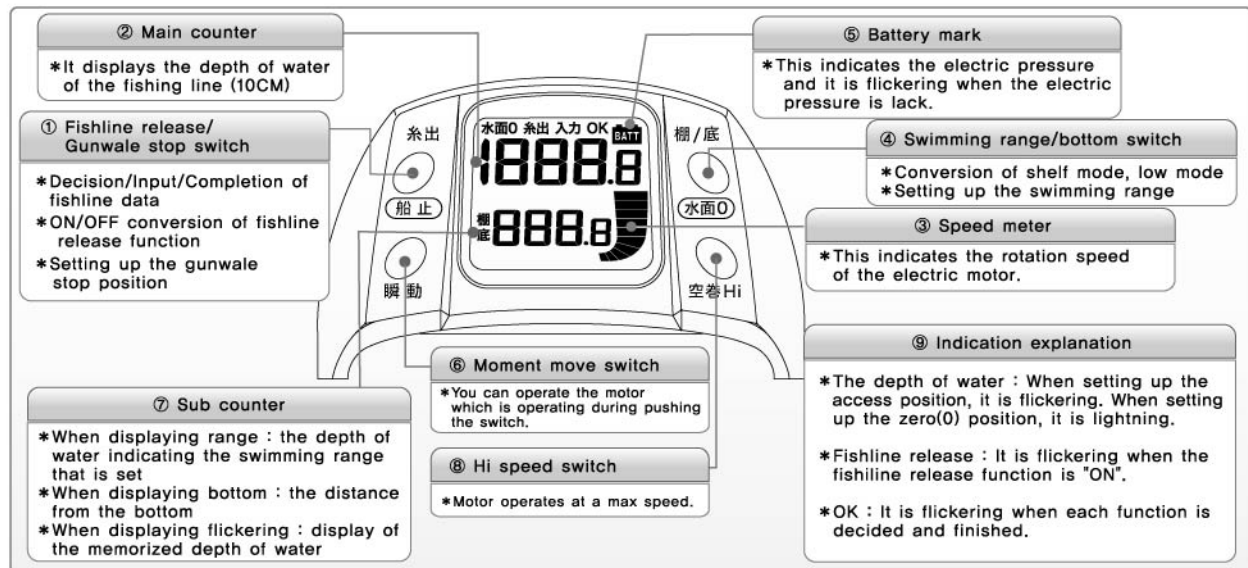

Attention

- ① In the picture, LCD screen is lightning for the explanation.
- ② If the temperature is below -10°C or over 60°C , you are difficult to recognize the LCD screen because of LCD. Please, notice this well.

7

Preparation before use

Power supply connecting method

- ❶ Please connect the power supply's clip to the battery.
Red clip → (+) terminal
Black clip → (-) terminal (refer to picture 1)
 - ❷ Deeply connect the "凸" of the power supply cord to the "凸" of the connector of the reel's main body and fix it by nut (refer to picture 2)
 - ❸ - 1 If the connection is well finished, the connection alarm will happen and initial setting will be displayed.
 - ❸ - 2 If the fishline is already inputted, LCD will show like "picture4" after setting screen.
 - ❹ At the picture4 status, if the electric pressure is normal, the battery mark will disappear in 5 minutes. If the battery mark does not disappear, the electric pressure of the your battery is low. Change or charge the battery.
 - ❺ If the status is like "picture 4 (the completion of the fishline data input)", you can not use the automatic winding function within the gunwale stop (5M) for your safety.
- * If the gunwale stop is not set up, the basic gunwale stop is 5M.
- * If you set up the depth of water more than 5M, you can use an automatic winding function.

Picture 1



Picture 2



Picture 3



Picture 4



Attention

- ❶ If you connect the power supply again, back-up function will operate.
- ❷ If you connect within 5 minutes after the disconnection, back-up screen will not be displayed, however, there is no problem at all.

Preparation before use

Fishing line data input method-A

- In case of using a inputted fishline data.

* This reel has 4 types of the fishline data.

PE6-1000m PE8-800m PE10-600m PE12-500m

- ① Please, connect the fishline to the spool by passing level wind.
- ② Please, check that LCD shows like "picture5" after connection.
(If the fishline is already inputted, the indication is different)
- ③ Please, push [line release/gunwale][船止/糸出] switch and [swimming/range][棚/底・水面] switch at the same time. LCD will show like "picture 6".
- ④ Please, push [line release/gunwale][船止/糸出] switch and select your fishline's number and length. Whenever you push the switch, the indication will be changed like "picture 7".

Picture 5



Picture 6



Picture 7

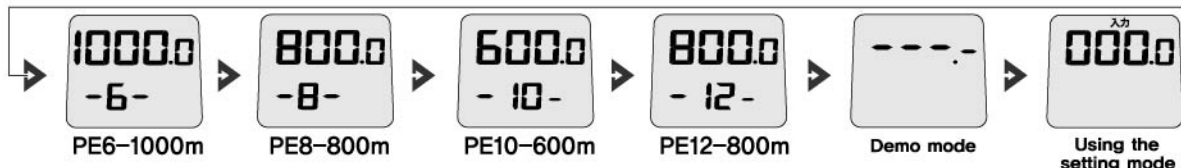

7

Preparation before use

- ⑤ Please push the on/off switch and wind the fishline after checking whether the fishline you would like to wind is corresponding or not.
- ⑥ The motor stops automatically before 15M of the selected fishline data.
After the motor stop wind the rest of fishline by pushing moment move function switch or handle.
- ⑦ When you finish the winding, push [swimming/range][棚/底・水面]switch and complete the input.
LCD will be changed like "picture 8"

Picture 8

- In the case of winding PE 8 line 800M.

798.5
8-8.0

Winding completion

[棚/底・水面]
[swimming/range]
Push the switch

水面0 糸出 入力 OK 自由
1888.8
水深 888.8

Setting screen

糸出
0.0

The input is completed



Attention

- ① When you wind the fishline, you need to give the load of 2kg ~ 3kg. Please, set the retrieve speed to lever's MAX position. If you wind in the indoor area for a long time, the motor rotation will stop by overheating prevention function. If the reel stops, please, restart it in 5 minutes.
- ② If you push [swimming/range][棚/底・水面]switch in demo mode screen, the existing data will disappear and the demo mode will be displayed.
- ③ If any errors happen during your operation, please push the [swimming/shelf][棚/底・水面]switch and restart it from the beginning.
- ④ Although the Indication of the depth of water is below $\pm 3\%$, the difference of the depth of water can happen because of the status of the expansion or contraction of the fishline.

Preparation before use

Fishline date input method-B

- You can use this in case that you know the type of the fishline data.
 - * Available fishline : PE 6/8/10/12, Nylon 14/16/18/20
 - * You can not input the fishline without the available fishlines.
- ① Please, connect the fishline to the spool through the level wind.
- ② Please, check whether the screen shows like "picture9" or not.
(If the fishline data is inputted, the indication is different)
- ③ Push [swimming/range][棚/底・水面] [line release/gunwale][船止/糸出] switch at the same time for 3 seconds. The screen will show like "picture10".
- ④ Push [line release/gunwale][船止/糸出] switch 5 times and choose the input mode.
- ⑤ Push [moment move][瞬動] switch and choose the fishline type, number.

Picture 9



Picture 10



Picture 12

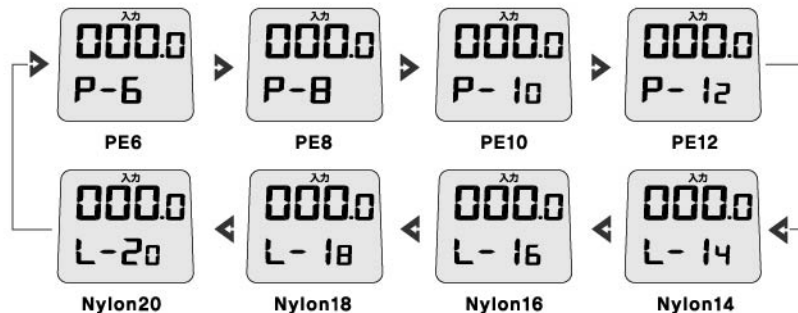

Picture 11



7

Preparation before use

- ⑥ please check your setting is correct or not and wind the fishline by controlling speed lever.
 ⑦ After winding the fishing line, please push the [swimming/shelf][棚/底・水面] switch [picture 13].

Picture 13



Attention

- When you wind the fishline, you need to give the fishline the load of 2kg ~ 3kg. Please, set the retrieve speed to lever's MAX position. If you wind in the indoor area for a long time, the motor rotation will stop by overheating prevention function. If the reel stops, please, restart it in 5 minutes.
- If any errors happen during your operation, please push the [swimming/range][棚/底・水面] switch and finish the working and restart it from the beginning.
- Although the Indication of the depth of water is below $\pm 3\%$, the difference of the depth of water can happen because of the status of the expansion or contraction of the fishline.
- When you push [swimming/range][棚/底・水面] switch in order to finish the data input, if the screen shows as below picture, the input method error or the control box error is expected.
- When the screen shows [-CE-], [-SE-], the reel needs repairing. Please, ask the shop you bought at to repair the reel.
- If the screen on the reel shows the errors as below pictures after finishing the fishline data input or during the inputting the fishline data, your input method is incorrect or the reel is expected to have a defect.

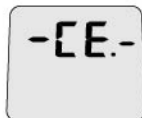

Control box error

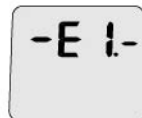

Short of the fishline



Spool rotation error

Operation method

1 The gunwale automatic stop

- You can set up the stop position of the automatic winding function with standing up the fishing rod in order to make the fishing line reach your hand.

Operation sequence ① : Set up the fishing tackle after releasing the fishline from the reel and connect the power supply to the reel.

Operation sequence ② : Adjust the fishline length in order to make the fishing line reach your hand.

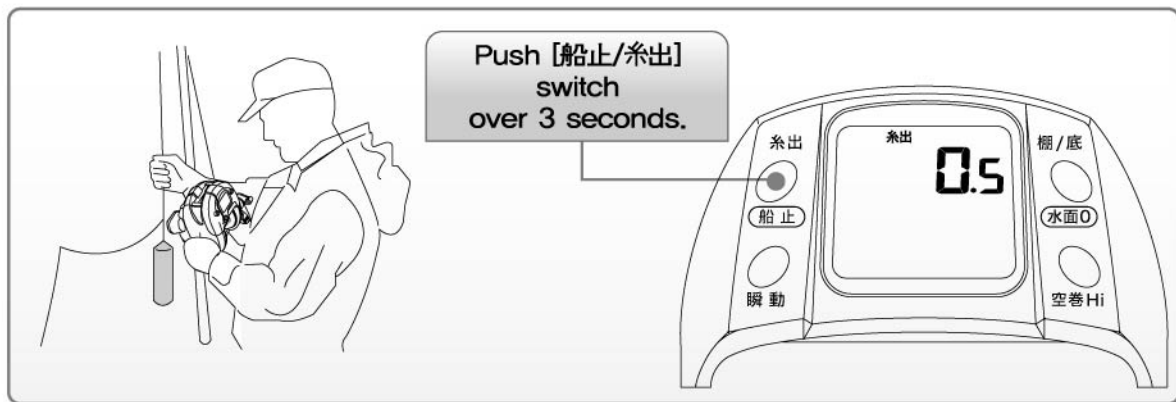

8

Operation method

Operation sequence ③ : Push [line release/gunwale][船止/糸出]switch over 3 seconds.

If the screen shows like (picture 14) with alarming, the stop position is finished.

- * At this time, [水面] is flickering.
- * You can set up [水面] consecutively.
- * "OK" will disappear after lightning for 5 seconds.

Picture 14

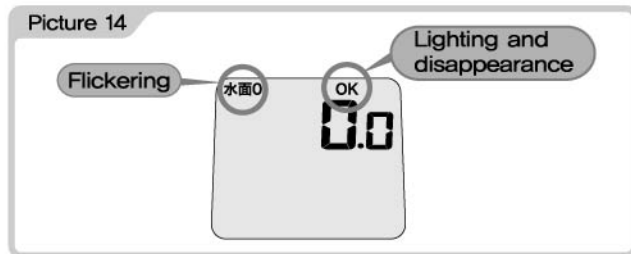

Attention

- ❶ If you release the fishing line without setting up the gunwale, the gunwale stop position is set up at 5M.
- ❷ The fishline can be contracted because of the load on the fishline, so this can cause differences.
- ❸ Although you do not set up the surface of water when [水面] is flickering, there is no problem doing fishing with releasing the fishing tackle.
The counter indication is over 10.0, so [水面] will disappear automatically.

Operation method

2 Setting up the surface of water

- In order to find the correct swimming range, make the surface of water at 0.0.
- * When finishing the gunwale stop position setting, [水面] on the screen will be flickering.(refer to picture15)

Picture 15

Flickering

水面0 糸出

0.0

Operation sequence ① : First, stand up your fishing rod and adjust the handle in order to make the fishing tackle be on the surface of water. When you wind the fishing tackle to the surface of water, the depth of water on the screen will be -0.0.



8

Operation method

Operation sequence ② : Push [swimming/range][棚/底・水面]switch. The position will be "0".
[水面] on the screen will be flickering and lightning and "OK" will be lightning.

* [水面] and "OK" will disappear automatically when the main counter is over 10.0.

Picture 16



Attention

- ① The function setting up the position of the surface of water is different from "the gunwale stop position setting" function.

Operation method

3 The function releasing the fishline

- When releasing the fishing line, the motor rotation help you release the fishing line easily.
* When the power supply is being connected, the function of releasing the fishline is "ON".

Operation explanation

- ① When releasing the fishing line, the motor will rotate automatically if the surface of water is over 10M from the gunwale stop position.
- ② When the spool rotation stops or backlashes during the motor operation, this function stops the motor rotation in order to prevent backlash.
- ③ The motor will restart to the direction that you released the fishing line with spool rotation.
- ④ If the swimming range is set up, the motor rotation will stop before 5M of the remembered depth of water.

How to off the function of releasing the fishline

- Push [line release/gunwale][船止/糸出]switch.
[糸出] on the screen will disappear.
- * If you want to make the line release function "ON", push [line release/gunwale][船止/糸出]switch again.
[糸出] on the screen will appear.

Picture 17

32.1

Picture 18

糸出
20.3

Attention

- ① If you are in a situation to stop the spool rotation or stop the motor rotation because of the backlash, minor TIME LAG can happen.
- ② When the motor is rotating with line release being "ON", sometimes it winds the fishline if you make the clutch "ON".

Operation method

4 Automatic winding and speed change method

- Motor operation and speed control by speed lever

Operation sequence ① : Pull the speed lever inwards in order to operate the motor.

* If the speed lever is not "OFF" when operating the motor, please, operate it after making the speed lever "OFF".

Operation sequence ② : You can change the speed by controlling the speed lever inwards and forwards.

* If you push the speed lever forwards, the speed of the winding fishline will be fast.

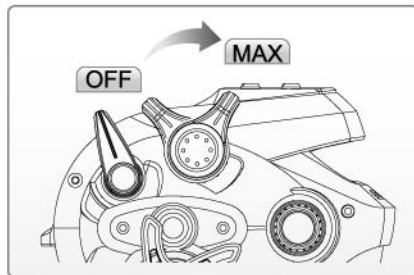
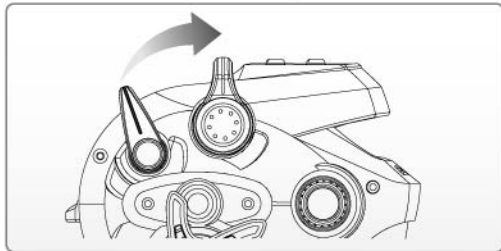

* If you pull the speed lever inwards, the speed of the winding fishline will be slow.

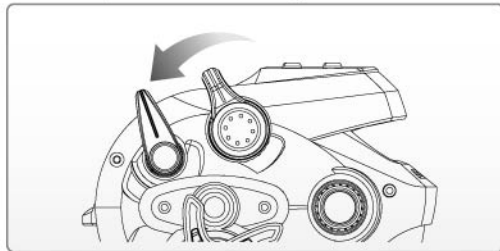

Attention

- ① You can not control the motor by the speed lever after the gunwale stop to prevent from the problem that the fishline is being caught into the reel, however, You can operate the moment move switch.

Operation method

5 Hi Speed

- This function makes you retrieve the fishing tackle at a high speed.

Operation Sequence ① : Push [空拳Hi] switch
You can wind consecutively at a max speed.

Operation Sequence ① : If you Push [空拳Hi] switch again, the motor will stop.

그림19



⑨ Hi Speed
(空拳Hi)

* Motor operates at a max speed
* Arranging motor's circuit
(In case of max speed)



Attention

- ① For your safety, [空拳Hi] function does not operate when the depth of water is under 10.0m.
- ② If you operate the speed lever during the winding at a max speed, you can change the speed because the speed lever adjustment becomes priority.
- ③ If you push [空拳Hi] switch while you are controlling the speed lever, the winding will operate at a max speed.
- ④ If the indication of the depth of water is under 10.0m, the speed is changed to L0-10 automatically because of the speed reduction section shortly before the gunwale.

Operation method

6 Swimming range mode

- This function alarms you when the fishline reaches the swimming range that many fishes live.

Operation sequence ① : Push [swimming/range][棚/底・水面] switch when the fishing line reaches the swimming range that you want to remember. Swimming range setting is finished.

- * The depth of water on the main counter will be displayed on the sub counter (refer to picture 20)
- * After setting, this function alarms you at the front of boat 5M whenever you release the fishing line.

Automatic remember of swimming range

- In case of setting up the depth of water that a fish was caught after retrieving the fishing tackle.

Operation sequence ① : Retrieve the fishing tackle.

- * If the indication of the main counter is below 10.0, the depth of water on the sub counter will be flickering. (refer to picture 21)

(The flickered depth of water means that the depth of water which stays on the bottom, at least, over 5 seconds)

Operation sequence ② : When the depth of water is flickering, if you push [swimming/range][棚/底・水面] switch, it will be lightning and swimming range will be set up. (refer to picture 22)

Picture 21

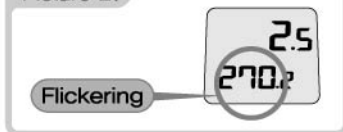

Picture 22

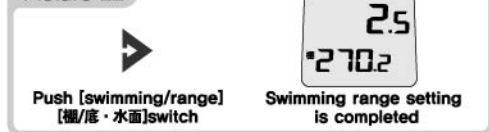

Picture 20



- * In case of releasing the fishing line over 10M without pushing [swimming/range][棚/底・水面] switch during the lightning.

- ① If the swimming range is already set up, the depth of water which is already set up will be displayed.
- ② If you do not set up the swimming range, it will disappear.

Operation method

Removal of swimming range mode

- If you push [swimming/range][棚/底・水面]switch over 2 seconds, the mode will be changed to the bottom mode.(refer to picture 23)
- * The remembered depth of water will disappear.
- * If you want to change the mode to the swimming range mode, please, push [swimming/range][棚/底・水面]switch again over 2 seconds.

Picture 23



Swimming range mode



Push [swimming/range]
[棚/底・水面]switch
over 2 seconds



Bottom mode



Attention

- ❶ It is impossible to set up the swimming range at below 10M.
- ❷ It is impossible to remove the swimming range setting while the motor is operating.

Operation method

6 The bottom mode

- It displays the distance from the bottom to the fishing tackle.

If the swimming / bottom on the sub counter is not displayed.

Operation sequence ① : Push [swimming/range][棚/底・水面]switch(refer to picture 24)

- * The swimming on the sub counter will be displayed.
- * If the indication of the main counter is over 10M, the swimming range will be set up.

Operation sequence ② : Push [swimming/range][棚/底・水面]switch again over 2 seconds.

- * [底0.0] on the sub counter will be displayed. (refer to picture 25)

Picture 24



Picture 25



Push [swimming/range]
[棚/底・水面]switch
over 2 seconds.



If swimming[棚] on the sub counter is displayed.

Operation sequence ① : Push [swimming/range][棚/底・水面]switch over 2 seconds.

- * swimming[棚] on the sub counter will be changed to [底0.0]. (refer to picture 26)

Picture 26



Push [swimming/range]
[棚/底・水面]switch
over 2 seconds.



Operation method

Bottom mode usage

Operation sequence ① : Wind the fishline to a tight degree after making the fishing tackle reach the bottom, not to make the fishline loose.

* The sub counter will show the fishline length you wind. (refer to picture27)

Operation sequence ② : Push [Swimming/bottom][棚/底・水面0]switch.

* The indication on the sub counter will be changed to [底 0.0]. (refer to picture28)

Picture 27



Retrieving the
loose fishline



Push [Swimming range]
[棚/底・水面0]switch.

Picture 28



Operation method

8 Correction of cut PE fishline

● If the fishline is cut by an obstacle of the bottom or a swellfish, you can correct the fishline data.

* You can only apply this function to the PE fishline which is cut over 10M.

Operation sequence ① : Retrieving the PE fishline and connect the fishing tackle to the PE fishline.

Operation sequence ② : Push [line release/gunwale][船止/糸出] switch over 3 seconds.(correction completion)

* The alarm will happen and 0.0 on the main counter will be displayed.

* OK" on the sub counter will be displayed.

Picture 29



Push [line release/gunwale]
[船止/糸出] switch over 3 seconds.



Correction completion

* After correcting the fishline length, please, reset "gunwale stop position", "the surface of water 0".



Attention

① After correcting the cut PE fishline, if you release the fishing tackle without setting up the gunwale stop position, the gunwale stop position will be 5M.

Convenient safety function

1 Battery checking

- This function checks the electric pressure of the battery when connecting the power supply.
- ① If the electric pressure is "OK", the flickered battery mark will disappear in 5 seconds.
- ② If the electric pressure is low, the battery mark will be lightning.
- * Exchange battery or recharge it.

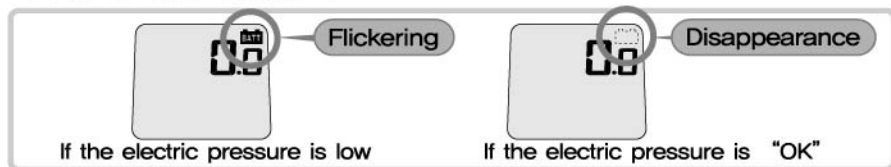

- ③ If the electric pressure of the power supply is higher than the proper electric pressure to the reel, the alarm will happen and warning sign on the screen will be displayed. Please, stop using this electric pressure at this case.



2 Gunwale speed reduction.

- ① To decrease the impact on the reel when stopping the reel, the speed reduction function operates before 3M of the gunwale stop position.
- ② If you wind the fishline by Hi speed[空巻Hi], the first speed reduction operates at the depth of water 10M and second speed reduction operates before 3M of the stop position.

Convenient safety function

3 Memory back up

- Although the reel's cord or clip is disconnected during the fishing, you do not need to be anxious. The depth of water or the other data is kept and memorized for approximately 10 minutes.



Attention

- ❶ Please, do not release or wind the fishline with the power supply cord being disconnected.

4 Overload control

- Whenever the motor has overload, the brake function will stop the motor rotation in order to protect the data and the alarm will happen.
- If you operate the speed lever after making the speed lever "OFF" once, the function will return.
- If you operate the reel with overload for a long time, the overheating prevention function will stop the motor. If the reel stops, please, restart it in 5 minutes.



Attention

- When you make the suspended function be normal, please, use it with the decreased overload.

5 Power up system

- When winding the fishline at a low or middle speed, If the spool rotation stops for approximately 10 seconds, the motor power will increase in order to keep the winding speed.
- After the power-up, if you operate the speed lever, the speed will return to the corresponding speed indication.
- If the spool does not rotate, although you raise the motor power(speed), after 5 minutes, overheating prevention function will stop the motor. If the motor stops, please, restart it in 5 minutes.

When fault is doubtful

Please, check the below list before requesting for inquiry or repair.

Symptoms	Expected factors	Confirmation & Handling Method
When the screen does not display at all	<ul style="list-style-type: none">● Power supply cord is not connected properly.● Disconnection of power supply.● Electric pressure of batter is not enough.	<ul style="list-style-type: none">● Connect correctly.● Talk with the shop.● Charge it or check another battery.
When number difference on the counter is too big	<ul style="list-style-type: none">● Error in setting up the fishline data.● Error due to the stretched fishline.	<ul style="list-style-type: none">● Input fishing line again.● Input fishing line again.
When Automatic winding does not work	<ul style="list-style-type: none">● If the indication is 0.0.● Shortage of battery's capacity.● When the connect cable is rusty.● When you are using the power of the ship(Wiring problem or the electric pressure is low)	<ul style="list-style-type: none">● Please display the surface of water over the sides of boat distance.● Charge it or use another battery.● After removing the rust, please check it.● Exchange an exclusive battery and please check it.

If you find the abnormal symptom after you check the above list, please prepare the details about the defectives and ask the repair to the shop where you purchased the reel.

Part list

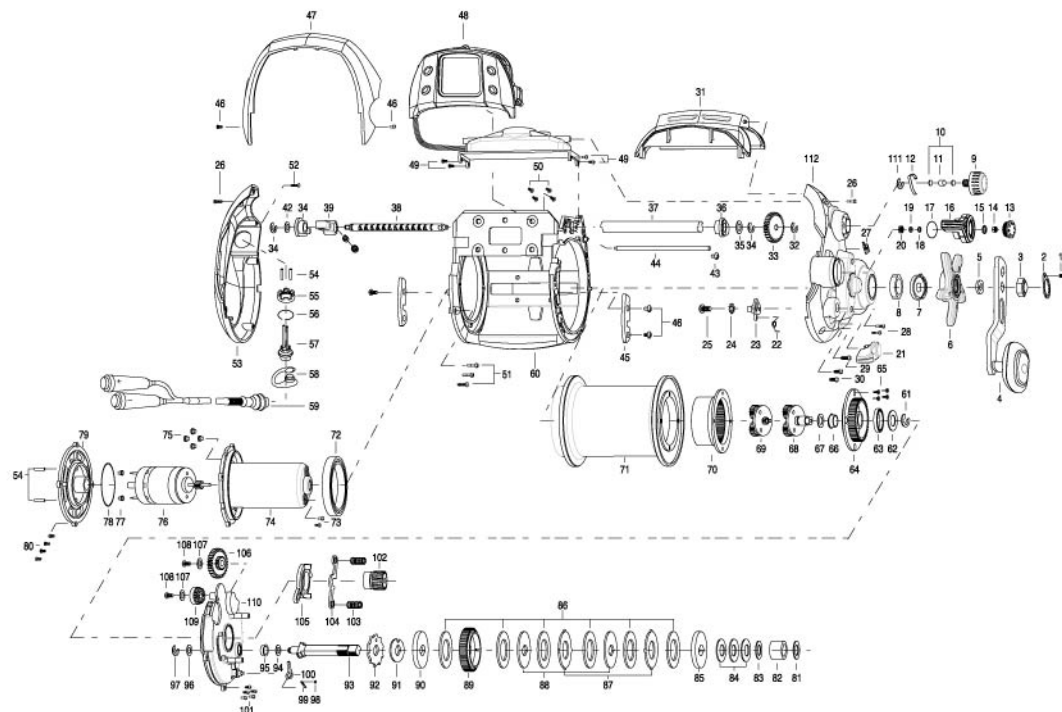

Key No.	Parts Name	Key No.	Parts Name	Key No.	Parts Name	Key No.	Parts Name
001	SCREW	033	TRAVERSE GEAR	063	BALL BEARING	094	WASHER
002	H/NUT PLATE	034	RETAINER	064	SPOOL COVER	095	BEARING
003	HANDLE NUT	035	WASHER	065	SCREW	096	WASHER
004	HANDLE ASSY	036	BUSH	066	BEARING	097	RETAINER
005	WASHER	037	PIPE	067	WASHER	098	O-RING
007	CLICK HOLDER ASSY	038	WORM SHAFT	068	GEAR SHAFT ASSY	099	CLAW SPRING
008	BUSH	039	LEVEL WIND ASSY	069	SUN GEAR ASSY	100	ANT CLAW
009	TENSION KNOB	040	LEVEL WIND PIN	070	INTERNAL GEAR	101	SCREW
010	WASHER	041	NUT CAP	071	SPOOL ASSY	102	PINION
011	WASHER	042	WASHER	072	BALL BEARING	103	COIL SPRING
012	LEAF SPRING	043	SCREW	073	SCREW	104	CLUTCH BAR
013	LEVER CAP	044	SHAFT-A	074	MOTOR BOX	105	CLUTCH CAM
014	NUT	045	GUARD PLATE	075	PACKING-C	106	JOINT GEAR
015	TOOTH WASHER	046	SCREW	076	MOTOR ASSY	107	WASHER
016	SPEED LEVER	047	FRONT COVER-A	077	PACKING-B	108	SCREW
017	O-RING-C	048	CONTROL BOX ASSY	078	O-RING-D	109	MAGNET ASSY
018	SPRING WASHER	049	SCREW	079	ONE WAY HOLDER ASSY	110	FRAME COVER ASSY
019	WASHER	050	TAP SCREW	080	SCREW	111	RETAINER
020	NUT	051	TAP SCREW	081	WASHER		
021	CLUTCH LEVER	052	TAP SCREW	082	DRAG COLLAR		
022	CAM SPRING	053	LEFT SIDE PLATE	083	WASHER		
023	CLUTCH LEVER CAM ASSY	054	TUBE	084	DRAG SPRING		
024	TOOTH WASHER	055	NUT	085	WASHER-D3		
025	SCREW	056	SPRING WASHER	086	WASHER		
026	SCREW	057	CONNECTOR ASSY	087	WASHER-A		
027	LINE STOPPER	058	WATER CAP	088	WASHER-D2		
028	SCREW	059	CODE ASSY	089	DRIVE GEAR		
029	SCREW	060	STAR DRAG	090	WASHER-D1		
030	SCREW	060	FRAME ASSY	091	WASHER-D		
031	FRONT COVER	061	RETAINER	092	RATCHET ASSY		
032	RETAINER	062	WASHER	093	GEAR METAL		

ba nax
www.banax.co.kr