



# Reel - Model 255 Parts List

## KEY# PART# DESCRIPTION

1	1-255	FRAME
2	2-255	SPOOL
3	3-255	ENDCAP
4	4-501	BEARING
5	5-502	BEARING CAP, LEFT
6	6-203	BEARING CAP, RIGHT
7	7-204	SCREW, ENDCAP (2)
8	8-205	JACK, ECCENTRIC
9	9-206	ECCENTRIC
10	10-207	SPRING, ECCENTRIC
11	11-208	LEVER, ECCENTRIC
12	12-509	WASHER, NYLON
13	13-510	SCREW, ECCENTRIC
14	14-211	BRIDGE
15	15-212	DOG
16	16-213	SPRING, DOG
17	17-214	WASHER, FIBER
18	18-215	MAIN GEAR
19	19-216	PINION GEAR
20	20-217	SCREW, UPPER BRIDGE (2)

## KEY# PART# DESCRIPTION

21	21-218	SCREW, LOWER BRIDGE (2)
22	22-219	WASHER, METAL DRAG (3)
23	23-220	WASHER, FIBER DRAG (3)
24	24-221	WASHER, DOME
25	25-222	YOKE
26	26-523	SPRING, YOKE (2)
27	27-224	SPACER, DRAG
28	28-225	STAR
29	29-226	HANDLE, 251
30	30-227	SCREW, HANDLE
31	31-528	SCREW, HANDLE LOCK
32	32-229	CLAMP SET, 251 LOWER
33	33-530	T-NUT (2)
34	34-531	STUD, LOWER CLAMP (2)
35	35-532	HEX NUT, LOWER CLAMP (2)
36	36-533	WASHER, CLAMP (2)
37	37-234	CLAMP, UPPER
38	38-535	SCREW, UPPER CLAMP (4)
39	39-238	CLAMP, LOWER
41	41-541	PRO GEAR WRENCH (NOT SHOWN)

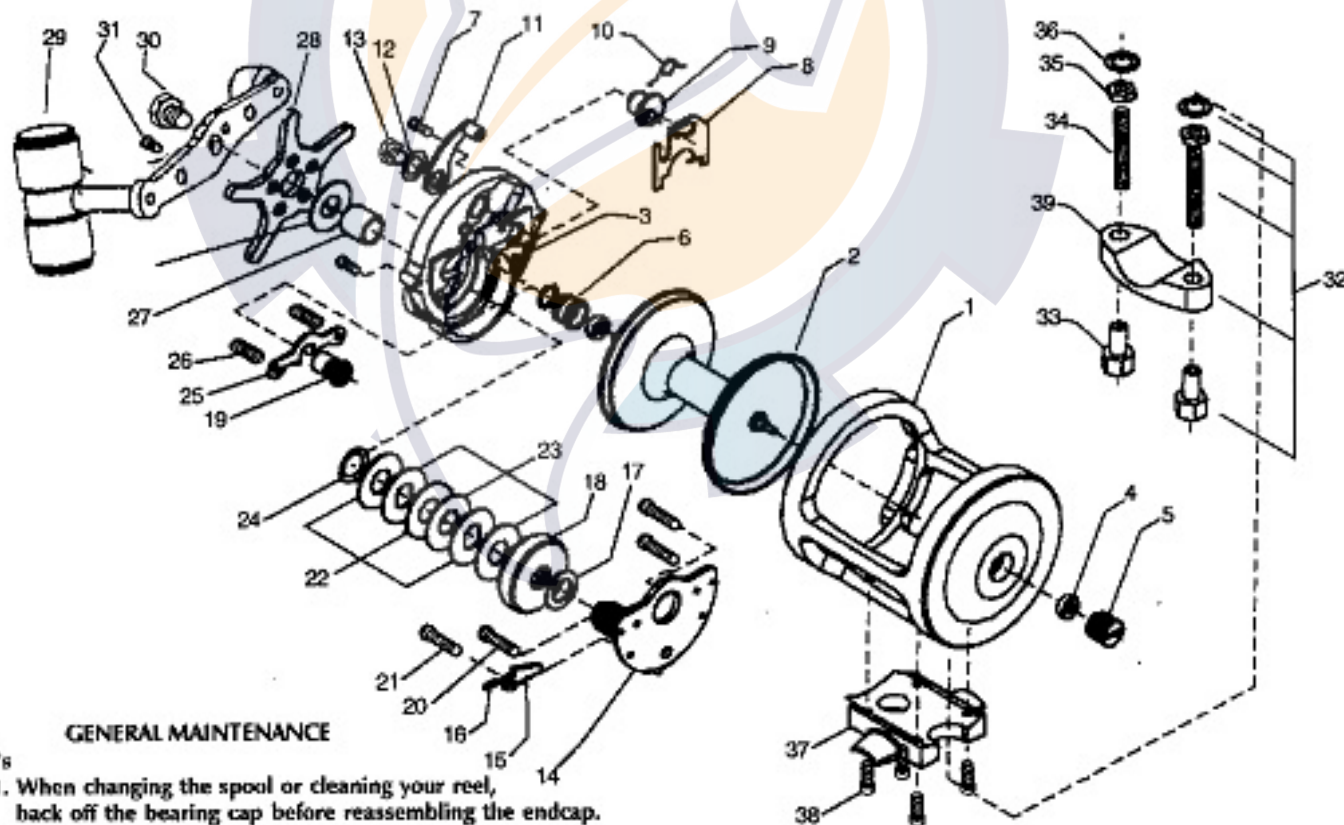

## GENERAL MAINTENANCE

### Do's

1. When changing the spool or cleaning your reel, back off the bearing cap before reassembling the endcap.
2. After cleaning your reel, lightly oil all moving parts.
3. Lightly lube between the frame and endcap before reinstalling.
4. If necessary, lightly oil the bearings with a recommended bearing oil.

### Don't

1. Do not over-tighten the screws.
2. Do not immerse in water when cleaning.
3. Do not over lubricate.
4. Do not over tighten the bearing cap.

Please see your authorized Pro Gear warranty station for complete service or parts.