

EXPLODED PARTS VIEW

Bantam *Black Magnum* 1000II

SHIMANO

1990 REPAIR MANUAL

Shimano American Corporation, One Shimano Dr.
Irvine, CA 92718

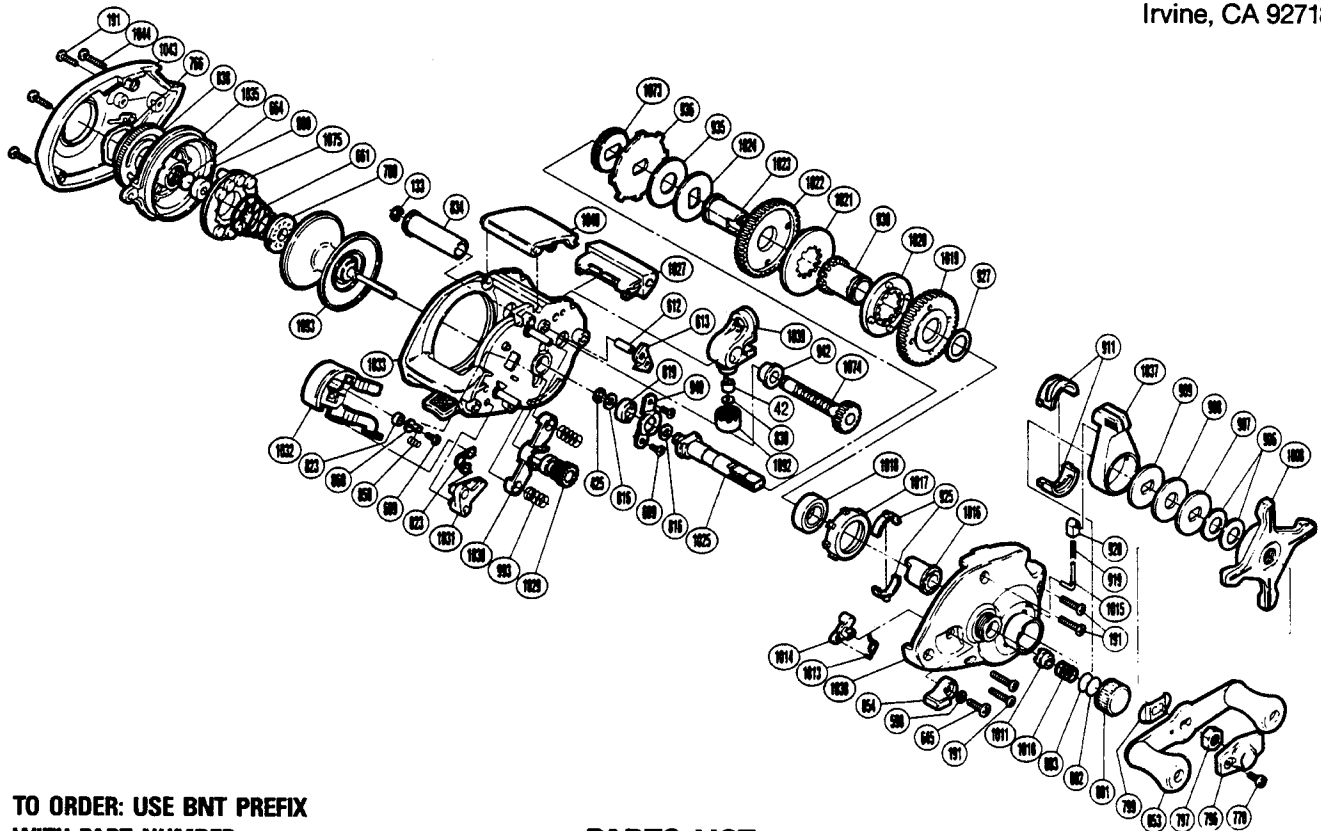

TO ORDER: USE BNT PREFIX
WITH PART NUMBER

PARTS LIST

BNT #	DESCRIPTION	BNT #	DESCRIPTION	BNT #	DESCRIPTION
0042	Line Guide Pawl	0853	Handle Assembly	1016	Drag Shaft (B)
0133	Worm Shaft Retainer	0854	Flipping Lever	1017	Bearing Holder
0191	Side Plate Screw	0859	Flipping Retractor Spring	1018	Drive Shaft Bearing (B)
0425	Clutchbutton Lock	0860	Yoke Plate Washer (B)	1019	Drive Gear (L)
0590	Lock Washer	0880	Spool Shaft Bushing (C)	1020	Shift Clutch (L)
0609	Drive Shaft Retainer Screw	0906	Coned Disc Spring	1021	Shift Clutch (H)
0612	Anti-Reverse Pawl Pin	0907	Key Washer (A)	1022	Drive Gear (H)
0613	Anti-Reverse Pawl	0908	Drag Washer (D)	1023	Drag Shaft (A)
0645	Flipping Lever Screw	0909	Key Washer (C)	1024	Drive Shaft Washer
0661	Magnet Retainer Spring	0911	Shift Cam	1025	Drive Shaft
0664	Spacer (B)	0919	Shift Spring	1027	Level Wind Protector
0766	Dial Friction Washer	0920	Shift Spring Guide (B)	1029	Pinion Gear
0770	Handle Nut Plate Screw	0925	Shift Arm	1030	Yoke
0780	Magnet Retainer Lock	0927	Drive Gear Washer	1031	Joint Plate
0796	Handle Nut Plate	0930	Shift Sleeve	1032	Clutch Button
0797	Handle Nut	0935	Drag Washer (A)	1033	One-Piece Frame
0799	Friction Washer	0936	Anti-Reverse Ratchet	1035	Dial Case
0801	Cast Control Cap	0940	Drive Shaft Retainer	1037	Shift Lever
0802	Spool Tension Spacer (B)	0942	Worm Bearing	1038	Right Side Plate
0803	Spool Tension Spacer (A)	0993	Yoke Spring	1039	Line Guide
0816	Drive Shaft Washer	1008	Star Drag	1040	Thumb Rest
0819	Drive Shaft Bushing	1010	Spool Tension Spring	1043	Left Side Plate
0823	Retractor Spring	1011	Spool Shaft Bushing (A)	1044	Left Side Plate Screw
0825	Yoke Plate Washer (A)	1013	Cam Spring	1073	Idle Gear
0830	Spacer (Optional)	1014	Flipping Cam	1074	Worm Shaft
0834	Level Wind Guard	1015	Shift Spring Guide (A)	1075	Magnet Retainer
0838	Magnetic Control Dial				