

### SPECIFICATIONS :

M FW / Lt SW

Line Capacity:

GW20 - 125 yds / 8 lb

GW40 - 140 yds / 12 lb

4 Ball Bearings

5.7:1 Gear Ratio

Retrieve Rate (inches per turn):

GW20 - 27.9"

GW40 - 29.8"

Weight:

GW20 - 10.4 oz.

GW40 - 11.6 oz.

### FEATURES :

Front Drag

Balanced Rotor

Balanced Handle (New for 1998 models)

Oversized Twist Reducer Line Roller B.B.

POSI-Loc Selective Anti-Reverse (15 stop)

Aluminum Long Stroke Max-Cast Spool

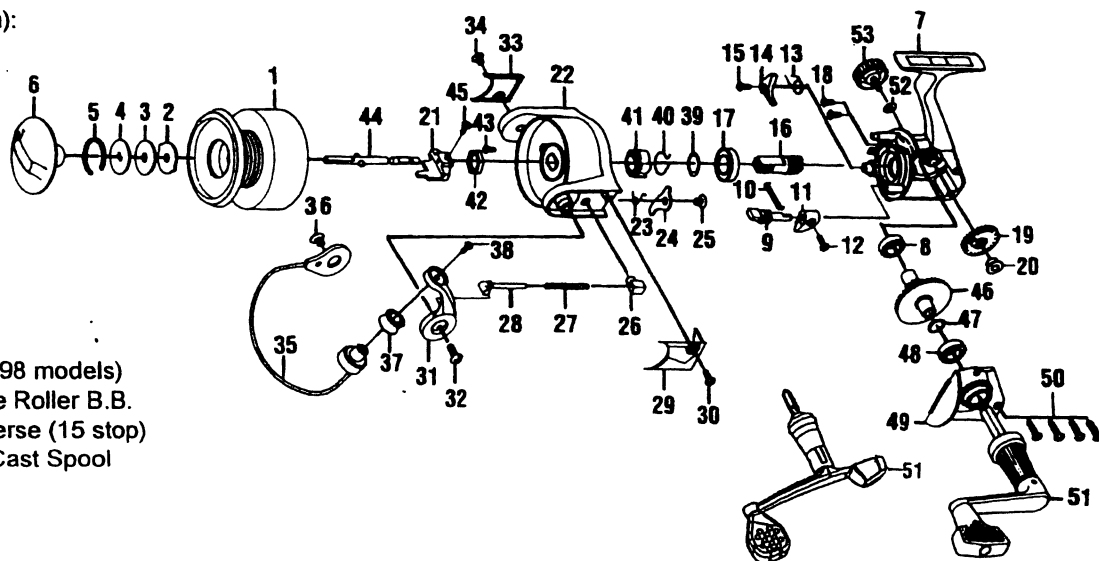

Key No.	Part No.	Part No.	DESCRIPTION	Price	Key No.	Part No.	Part No.	DESCRIPTION	Price
1	BH321-13	BH321-23	Spool Assembly	8.22	28	BH031-11	BH031-21	Spring Shaft	0.96
2	BH081-11	BH081-21	Spool Washer "A"	0.59	29	BH046-13	BH046-23	Arm Lever Cover	2.22
3	BH033-11	BH033-21	Spool Washer "B"	0.64	30	BH085-13	←	Cover Screw	0.47
4	BH080-11	BH080-21	Spool Washer "D"	0.96	31	BH007-13	←	Arm Lever	2.44
5	BH038-11	BH038-21	Drag Retainer	1.01	32	BH044-13	←	Arm Lever Screw	0.42
6	BH332-13	BH332-23	Drag Knob Assembly	3.03	33	BH024-13	←	Bail Holder Cover	0.84
7	BH001-13	BH001-23	Body (before A8 date code)	3.92	34	BH085-13	←	Cover Screw	0.47
7	BH001-27	←	Body (after A8 date code)	3.92	35	BH347-13	BH347-23	Bail Assembly	5.09
8	BH027-12	←	Ball Bearing	6.58	36	BH044-13	←	Bail Holder Screw	0.42
9	BH090-11	←	Stopper Cam	1.60	37	BH004-14	←	Line Roller BB	4.14
10	BH089-11	←	Stopper Cam Spring	0.96	38	BH108-13	←	Bail Screw	0.42
11	BH059-14	←	Stopper Lever	1.08	39	BH110-11	←	Bearing Washer	0.54
12	BH135-12	←	Stopper Lever Screw	0.64	40	BH086-11	←	Silent Spring	1.65
13	BH061-11	←	Stopper Spring	0.46	41	BH060-12	←	Ratchet Gear	1.75
14	BH063-12	←	Stopper	1.49	42	BH006-11	←	Rotor Nut	1.11
15	BH077-11	←	Stopper Screw	0.64	43	BH094-11	←	Rotor Nut Lock Screw	0.64
16	BH011-13	←	Pinion Gear (before A8 date code)	2.76	44	BH315-11	←	Main Shaft Assembly	5.73
16	BH011-14	←	Pinion Gear (after A8 date code)	2.76	45	BH100-11	←	Main Shaft Screw	0.64
17	BH028-11	←	Ball Bearing (before A8 date code)	8.70	46	BH012-13	←	Driver Gear	2.49
17	BH028-12	←	Ball Bearing (after A8 date code)	8.70	47	BH026-11	←	Adjust Washer	0.69
18	BH041-11	←	Bearing Screw	0.64	48	BH027-12	←	Ball Bearing	6.58
19	BH053-11	BH053-21	O/S Gear	1.53	49	BH023-13	BH023-23	Body Cover	2.34
20	BH158-11	←	O/S Gear Bushing	0.98	50	BH057-13	←	Body Cover Screw	0.42
21	BH025-11	←	O/S Slider	2.66	51	BH318-13	←	Handle Assembly	4.51
22	BH009-13	BH009-23	Rotor	3.98	51	BH318-17	←	Balanced Handle (1998 models)	5.00
23	BH049-11	BH049-21	Kick Lever Spring	0.96	52	BH105-11	←	Handle Cap Washer	0.47
24	BH019-11	BH019-21	Kick Lever	1.91	53	BH073-13	←	Handle Screw Cap	2.34
25	BH136-11	←	Kick Lever Screw	0.64					
26	BH020-11	←	Spring Holder	0.96					
27	BH022-11	BH022-21	Arm Lever Spring	0.64					

↙ = Changed to Balanced Handle for 1998 models.

☐ = These parts are not interchangeable with parts from different date code (ie., use Pinion Gear before A8 along with Ball Bearing and Body before A8)

MODEL

INTRODUCED : 1997

EFFECTIVE DATE OF

PARTS LIST/DIAGRAM: Sept. '98

DISCONTINUED : N/A