

How to Disassemble Abu 6500 C3CT Mag Elite

How to Disassemble Abu 6500 C3CT Mag Elite

by spudgun » Tue Jan 20, 2009 11:29 pm

Too much time on my hands. Nuff said. 😊

Hope it helps though. 😊

Download Abu Reel Schematics from here:

http://www.abugarcia.com/product_schematic.php

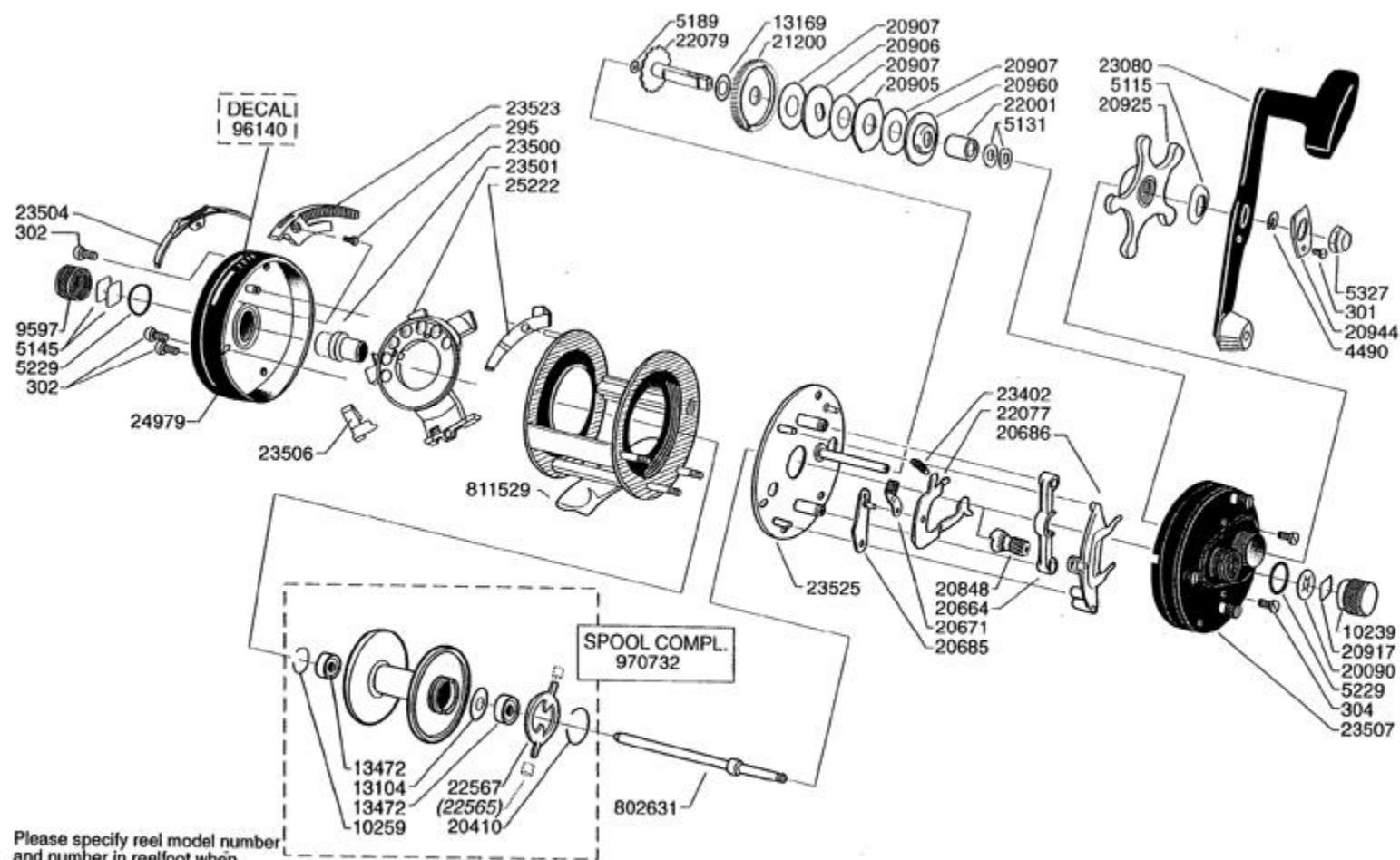

Please specify reel model number
and number in reelfoot when
ordering parts

Vid beställning av reservdelar bör
alltid rulltyp och nummer-
beteckning under rullfoten anges

Ambassadeur 6500 C3 CT MAG 09 00

901984 / A Green

34-12201-1

(93)

Parts of the Abu Ambassadeur 6500 C3CT Mag Elite:





How to assemble Abu Ambassadeur 6500 C3CT Mag Elite:

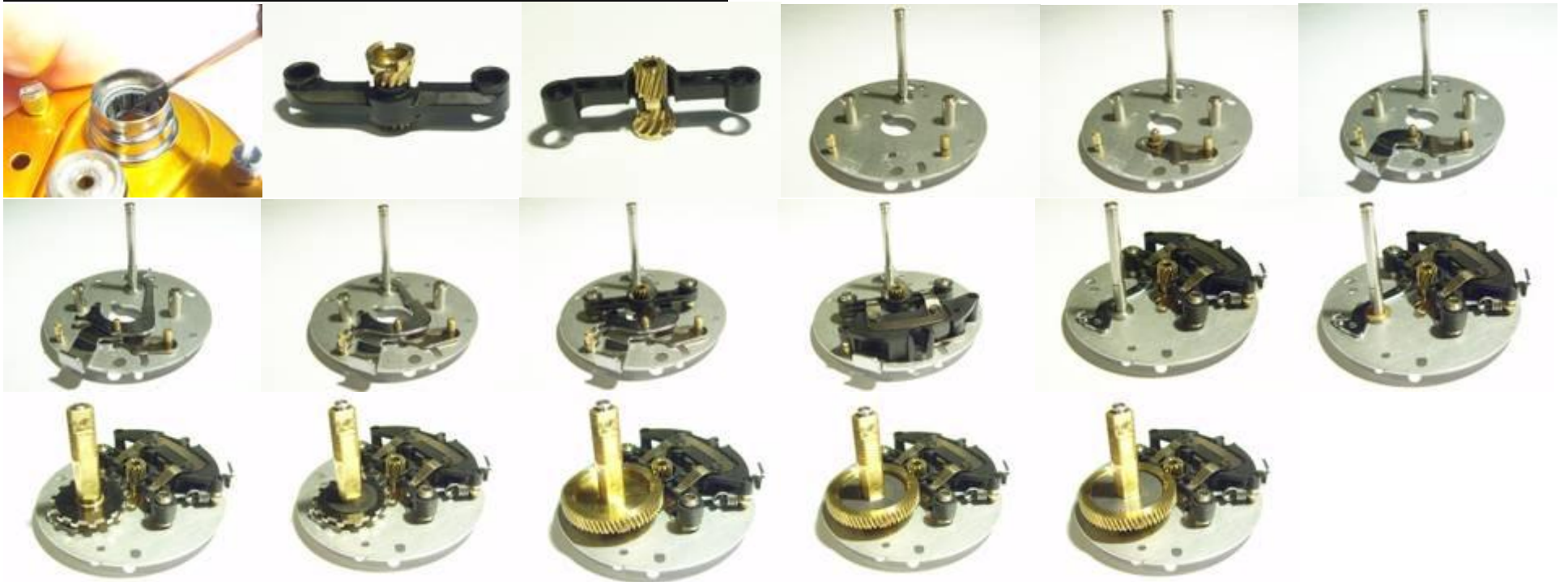





Abu Ambassadeur 6500 C3CT Mag Elite Disassembly Video:

<object width="425" height="344"><param name="movie"
value="http://www.youtube.com/v/aYA_ZQq0ayU&hl=en&fs=1"></param><param name="allowFullScreen"
value="true"></param><param name="allowscriptaccess" value="always"></param><embed

src="http://www.youtube.com/v/aYA_ZQq0ayU&hl=en&fs=1" type="application/x-shockwave-flash"
allowscriptaccess="always" allowfullscreen="true" width="425" height="344"></embed></object>

Abu Ambassadeur 6500 C3CT Mag Elite Assembly Video:

<object width="425" height="344"><param name="movie"
value="http://www.youtube.com/v/DTlrULWk2bE&hl=en&fs=1"></param><param name="allowFullScreen"
value="true"></param><param name="allowscriptaccess" value="always"></param><embed
src="http://www.youtube.com/v/DTlrULWk2bE&hl=en&fs=1" type="application/x-shockwave-flash"
allowscriptaccess="always" allowfullscreen="true" width="425" height="344"></embed></object>

Abu Ambassadeur 6500 C3CT Mag Elite Assembly Video for Mr Duffy: 😊😎

<object width="425" height="344"><param name="movie"
value="http://www.youtube.com/v/L38SliQoP70&hl=en&fs=1"></param><param name="allowFullScreen"
value="true"></param><param name="allowscriptaccess" value="always"></param><embed
src="http://www.youtube.com/v/L38SliQoP70&hl=en&fs=1" type="application/x-shockwave-flash"
allowscriptaccess="always" allowfullscreen="true" width="425" height="344"></embed></object>



Even Mindless Violence Seems Boring Today.

Species caught this year:

Gadus morhua
Merlangius merlangus
Limanda limanda
Scyliorhinus canicula

Pthirus pubis
Chlamydia trachomatis



spudgun

Reel Master

Posts: 3295

Joined: Sun Jan 27, 2008 6:59 pm

Location: Everyone sounds scouse now :(

Top

by sparky » Wed Jan 21, 2009 12:34 am

Nice one Jon. I must admit I had a bit of a dilemma positioning part #23506

I think it's the magnet housing spring.

Any chance of a close-up with it in situ so I can see if I got it spot on. 🧐

"No trees were killed in the sending of this message, but a large number of electrons were terribly inconvenienced....."

Whitefields "God with a rod"

<http://www.rnli.org.uk>

<https://www.facebook.com/Sparky27>



sparky

BLAS Sea Committee

Posts: 3142

Joined: Mon Nov 24, 2003 11:16 pm

Location: Whitefield Manchester

Top

by Jason Mc » Wed Jan 21, 2009 1:38 am

send it to pete coogan, much less hassle!! 😊 but very informative jon, cheers! 😊

Coarse Species 2010: Common Carp, Tench, Perch, Rudd, Roach, Bream, Barbel, Chubb, Gudgeon

Sea Species 2010: Codling, Whiting, Dab



Jason Mc

Obsessed Poster

Posts: 583

Joined: Tue Nov 27, 2007 8:58 pm

Location: Hoylake, Wirral

•
•

Top

by spudgun » Wed Jan 21, 2009 8:19 am

sparky wrote: Nice one Jon. I must admit I had a bit of a dilemma positioning part #23506

I think it's the magnet housing spring.

Any chance of a close-up with it in situ so I can see if I got it spot on. 😊

I know what you mean Bill, that's the reason I started it. Could never get it right even with the schematic.

There's a few ways you can position the spring but only the one way will work:

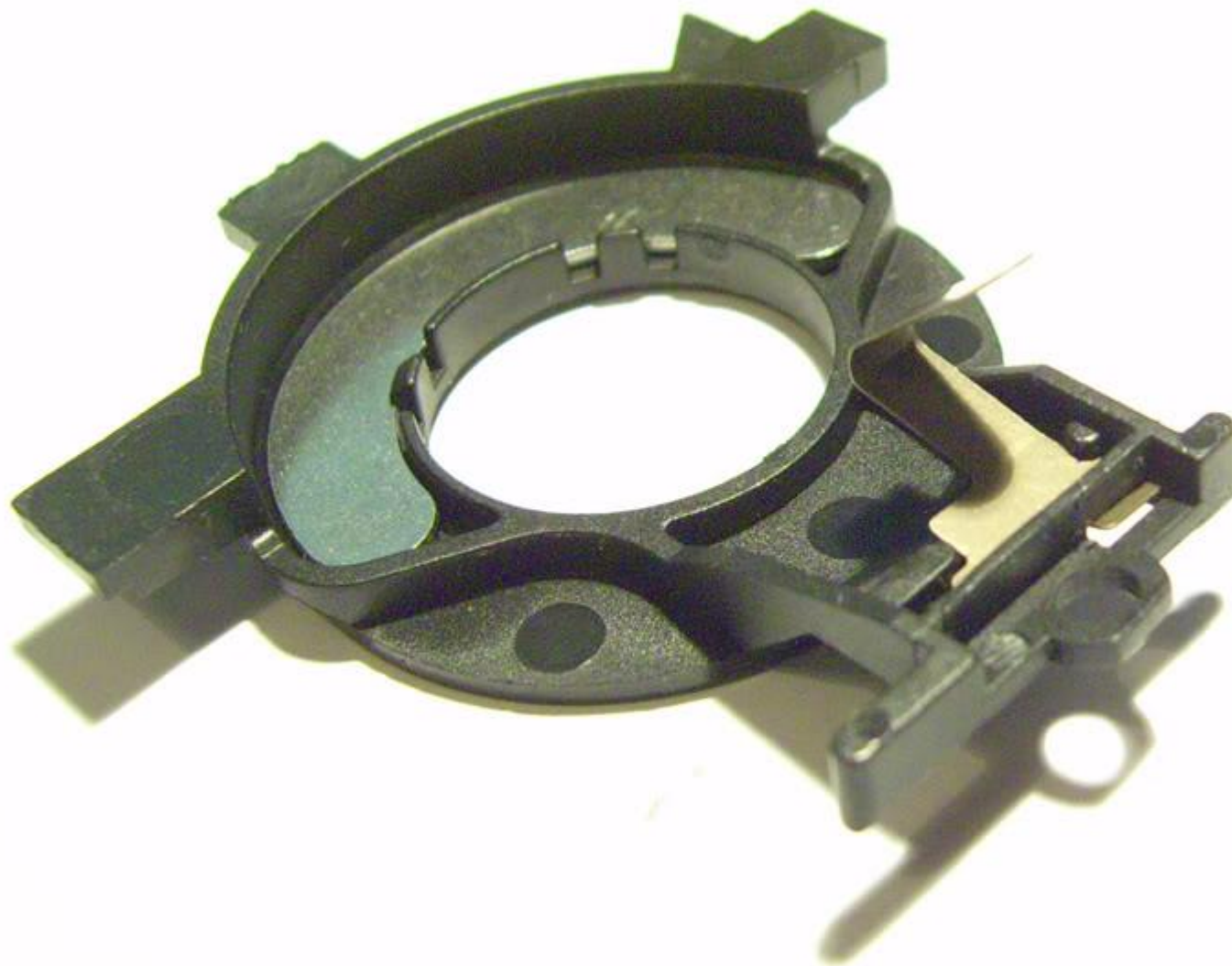

You also need to slide the mag adjuster (23504 and 23523) in the right position for it to engage the ratchet spring (25222) and the top of the mag housing (23501).



P.S. all thumbnails are clickable. 😎



Even Mindless Violence Seems Boring Today.

Species caught this year:

Gadus morhua

Merlangius merlangus

Limanda limanda

Scylliorhinus canicula

Pthirus pubis

Chlamydia trachomatis

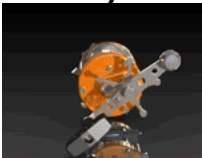

spudgun

Reel Master

Posts: 3295

Joined: Sun Jan 27, 2008 6:59 pm

Location: Everyone sounds scouse now :(

Top

by Steve Duffy » Wed Jan 21, 2009 8:36 am

Outstanding Jon. 😎

D.I.L.L.I.G.A.F

AGNB

Thats bang out of order !



Steve Duffy

has crabs

Posts: 12766

Joined: Mon Nov 24, 2003 9:37 am

Location: Heswall, Wirral.

•

Top

by **sparky** » Wed Jan 21, 2009 1:31 pm

Cheers Mate 😊

.

"No trees were killed in the sending of this message, but a large number of electrons were terribly inconvenienced....."

Whitefields "God with a rod"

<http://www.rnli.org.uk>

<https://www.facebook.com/Sparky27>



sparky

BLAS Sea Committee

Posts: 3142

Joined: Mon Nov 24, 2003 11:16 pm

Location: Whitefield Manchester

Top

by Big Kev » Wed Jan 21, 2009 4:35 pm

Good stuff Jon laaaaaaaaaaaaaaaaaaaaaa 😊

2013...cod..6-10-0...plaice...1-8-0....Starry Smoothhound...11-4-0....Common Smoothound...4-0-0



Big Kev

The Masterful One

Posts: 12577

Joined: Fri Jul 22, 2005 2:04 pm

Location: Sutton Manor....The Posh Part Of St Helens

Top

by JAGS » Wed Jan 21, 2009 5:38 pm

spot on john laaaaaaa yibady yabada 😊

<http://www.buccaneersbac.com/index.php>

THE BOAT ANGLING COMMUNITY

HOME OF THE SAN MIGUEL



JAGS

Obsessed Poster

Posts: 2593

Joined: Mon Sep 10, 2007 7:50 pm

Location: WALTON LIVERPOOL

Top

by Shaun1118 » Wed Jan 21, 2009 5:44 pm

Jon for knighthood 😊

2013 Species; Whiting, Pouting, Shore Rockling, Dogfish, Common Blenny, Dab, Flounder, plaice, Bass, Lesser Weever, 5bd slug, Bull Huss, Coalie, Pollock, Ballan Wrasse, silver eel, Launce, Mackerel, Corkwing, goldsinny, Starry Smoothhound,



Shaun1118

Sapper McMan !!!

Posts: 3800

Joined: Mon Feb 05, 2007 1:11 pm

Location: Liverpool or Ruthin

Top

by mrs wormy » Thu Jan 22, 2009 5:43 pm

cracking post that mate well done 😊😊

""il meet you on the bank""time and tide waits for no man lol

mrs wormy

Regular Poster

Posts: 59

Joined: Wed Dec 12, 2007 6:02 pm

Location: kinmel bay,north wales

Top

by davinski » Sun Mar 22, 2009 9:25 am

Just picked up on the thread. Excellent pics and information 😊😊😊

Sea fishermen are born honest. But they soon get over it.

davinski

Willy Wonka but needs a Humpalumpa

Posts: 2310

Joined: Thu Feb 01, 2007 10:26 pm

Location: greasby

Top

by History » Sun Mar 22, 2009 1:28 pm

Very Good 😊

History

Top

by FishermanDan » Tue Jul 21, 2009 9:25 pm

"How to Disassemble Abu 6500 C3CT Mag Elite" is not the issue; getting the buggers back together is the tricky bit! They are beautiful reels to use and I love them. However, reassembling one after merely taking off the spool-end side plate (i.e. the one without the handle) requires some know-how that is far from intuitive!

Apparently Abu was originally a watch-making company, which won't surprise anyone who's ever had the misfortune to disassemble one!.....

...And my Maudlin shall sing you one of her best ballads; for she and I both love all anglers, they be such honest, civil, quiet men.



FishermanDan

Super Poster

Posts: 178

Joined: Fri Apr 18, 2008 10:22 pm

Location: West Kirby

Top

by blankman » Tue Apr 27, 2010 7:58 pm

Is there an easy way of removing the C clip (Part 4490)? Top tunes too. 😎

Fecken CRABS!!

blankman

Super Poster

Posts: 110

Joined: Mon Jul 07, 2008 6:19 pm

Location: Moreton

Top

by blankman » Tue Apr 27, 2010 8:37 pm

Just got it off with pliers:)

But the fecken thing pinged off some where in the garage.

I've called off the search doesn't look like theres much hope 😞

Where can i get a new one from ?

Fecken CRABS!!

blankman

Super Poster

Posts: 110

Joined: Mon Jul 07, 2008 6:19 pm

Location: Moreton

by spudgun » Tue Apr 27, 2010 9:54 pm

*blankman wrote:*Is there an easy way of removing the C clip (Part 4490)? Top tunes too. 😏

Use a fine flat head screw driver to pri the C clip off using your finger to stop it pining off into the unknown. 😊😂

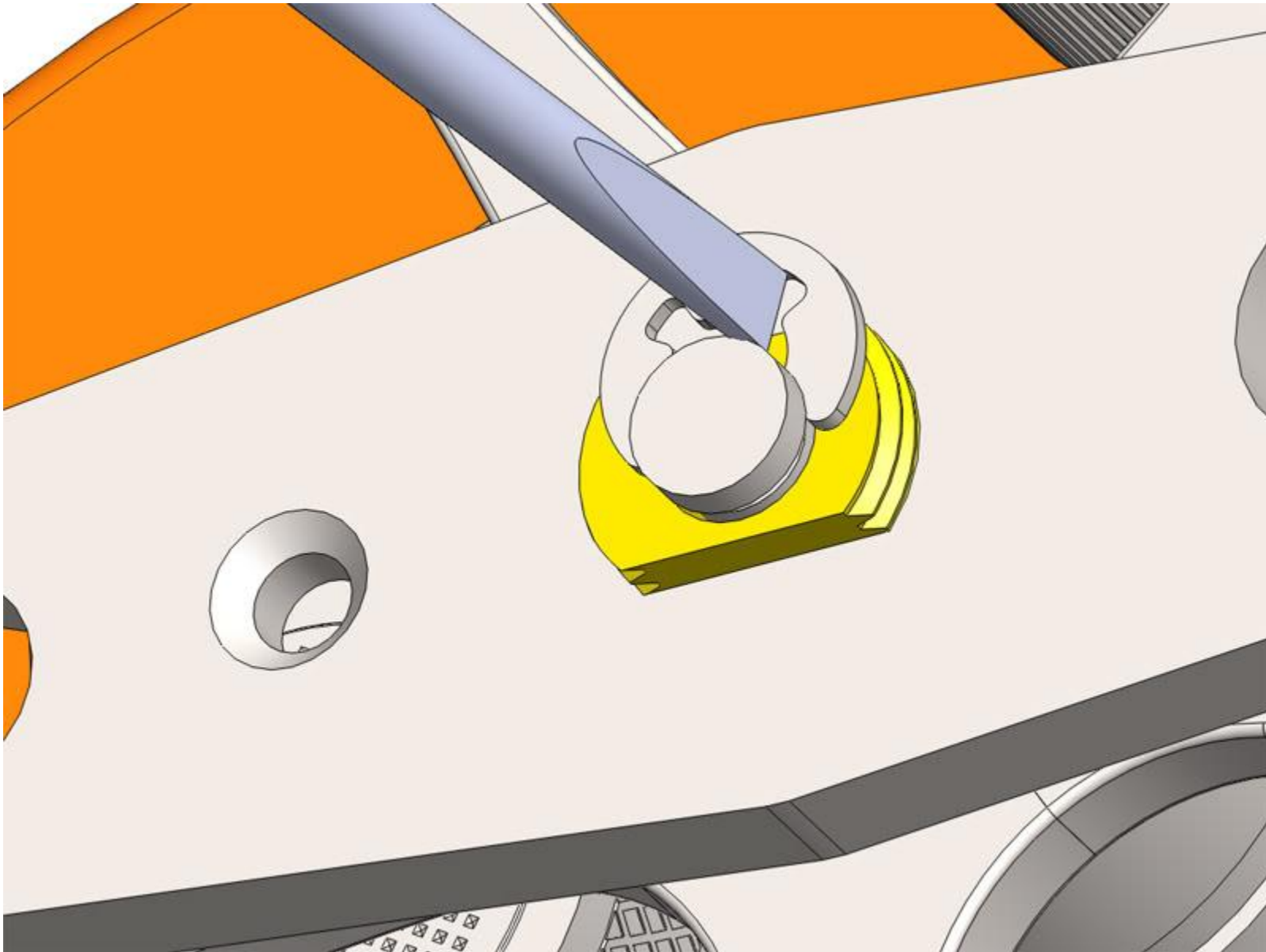



Even Mindless Violence Seems Boring Today.

Species caught this year:

Gadus morhua

Merlangius merlangus

Limanda limanda

Scyllorhinus canicula

Pthirus pubis

Chlamydia trachomatis

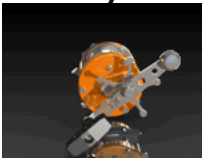

spudgun

Reel Master

Posts: 3295

Joined: Sun Jan 27, 2008 6:59 pm

Location: Everyone sounds scouse now :(

Top

Re: How to Disassemble Abu 6500 C3CT Mag Elite

by Wildgoose » Sat Oct 16, 2010 11:21 am

Can Someone Offer Me Some Advice Please?

I've got the older green version of the 6500 C3CT Mag Elite. When I bought it secondhand it had no brake blocks inside it (Pt

Nos: 22565). I've just about got use to it now, with only the occasional nest at the start of a cast.

😬Is it worth me obtaining 2 brake blocks to further reduce the chance of a nest - on the ABU schematic layout it includes them but I've looked at Utube stripdowns and they are also missing ???

Wildgoose



Wildgoose

Super Poster

Posts: 137

Joined: Wed Oct 14, 2009 8:55 am

Location: Chester

Top

Re: How to Disassemble Abu 6500 C3CT Mag Elite

by spudgun » Sat Oct 16, 2010 11:32 am

*Wildgoose wrote:*Can Someone Offer Me Some Advice Please?

I've got the older green version of the 6500 C3CT Mag Elite. When I bought it secondhand it had no brake blocks inside it (Pt Nos: 22565). I've just about got use to it now, with only the occasional nest at the start of a cast.

😬Is it worth me obtaining 2 brake blocks to further reduce the chance of a nest - on the ABU schematic layout it includes them but I've looked at Utube stripdowns and they are also missing ???

You put the brake blocks in like this.



Be careful they don't fall off when you put it back together. Search the forum for Pete Coogan. He'll sort you out with spares. I've put his contact details on here somewhere.

I tried using the reel without the blocks and ended up fluffing it all the time. The mags are not enough alone unless you've got a nice smooth cast.

For the time being you could make do with a very small bead or but a short length of wire insulation or a length off a cotton bud.



Even Mindless Violence Seems Boring Today.

Species caught this year:

Gadus morhua

Merlangius merlangus

Limanda limanda

Scyllorhinus canicula

Pthirus pubis

Chlamydia trachomatis



spudgun

Reel Master

Posts: 3295

Joined: Sun Jan 27, 2008 6:59 pm

Location: Everyone sounds scouse now :(

Top

Re: How to Disassemble Abu 6500 C3CT Mag Elite

by Wildgoose » Sat Oct 16, 2010 2:38 pm

Great info - I'll obtain some and get them fitted asap.

Thanks again.

Paul

Wildgoose



Wildgoose

Super Poster

Posts: 137

Joined: Wed Oct 14, 2009 8:55 am

Location: Chester

[Top](#)

Re: How to Disassemble Abu 6500 C3CT Mag Elite

by [carl24bpool](#) » Tue Nov 16, 2010 8:27 am

Possibly not the best solution but I normally take a piece of wire and remove the core, leaving a tube of insulation. I then cut the tube down with a blade to the right size for a brake block and use them.

For the price of the brakes you're probably as well buying them but I needed some quick so I improvised.

Also if youre doing okay without them, I'd suggest only fitting one of them to the spool and if you need more then use the mag brakes on a very low setting. The thing with the brake blocks is that you can't adjust them when youre out fishing and I'd advise against splitting your reel open on the beach. lol.

"I'm off fishing Doris!!!"