

OCEAN CITY'S "SEATTLE" REELS NOS. 109, 209, 110 AND 210  
(Model C)

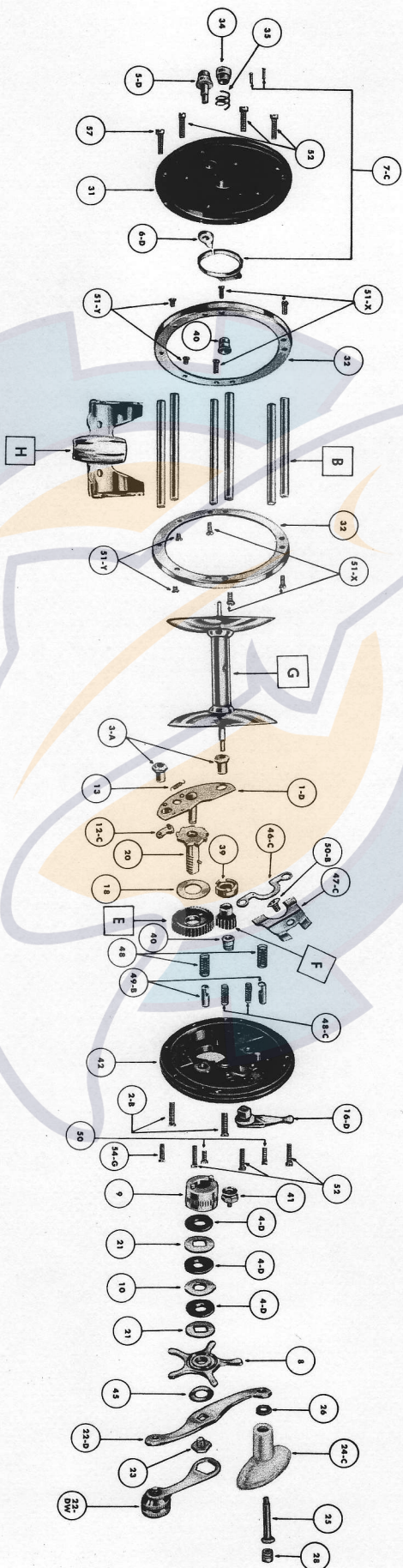

HOW TO ORDER PARTS FOR YOUR REEL—locate the part desired in the illustration above and note part number. When ordering, state quantity, part name and model letter which you will find on underside of reel stand. Enclose money order, stamps or check. Our minimum charge for one order is \$.25; please add \$.13 on each order for return postage and insurance.

| PART No. | PART NAME               | PRICE | PART No. | PART NAME  | PRICE | PART No. | PART NAME                                | PRICE | PART No. | PART NAME                          | PRICE |
|----------|-------------------------|-------|----------|--|-------|----------|--|-------|----------|------------------------------------|-------|
| 1-D      | Bridge                  | .40   | 16-D     | Free Spool Lever   | .50   | 32       | Left and Right Side Plate Ring           | .50   | 41       | Right Side Adjusting Cap           | .12   |
| 2-8      | Bridge Screw            | .02   | 19-F     | Frame Post (for Nos. 110 and 210)                          | .12   | 34       | Left Side Oil Cap                        | .12   | 44-M     | Spool (for Model Nos. 109 and 209) | 1.75  |
| 3-A      | Bridge Nut              | .05   | 19-G     | Frame Post (for Nos. 109 and 209)                          | .12   | 35       | Left Side Oil Cap Spring                 | .04   | 44-N     | Spool (for Model Nos. 110 and 210) | 2.10  |
| 4-D      | Brake Lining Washer     | .05   | 20       | Gear Sleeve and Lock Pin                                   | .75   | 40       | Left and Right Side Bearing              | .20   | 43-I     | Stand (for Model Nos. 109 and 209) | .80   |
| 5-D      | Click Button            | .16   | 22-D     | Handle Complete with Part Nos. 24-C, 25, 26, 28, and 22-DW | 1.50  |          | Main Gear (for Model Nos. 109 and 110)   | .90   | 43-J     | Stand (for Model Nos. 110 and 210) | 1.00  |
| 6-D      | Click Pawl              | .12   | 22-DW    | Handle Wrench only   | .40   | 37       | Main Gear (for Model Nos. 109 and 110)   | .90   | 46-C     | Yoke Plate                         | .26   |
| 7-C      | Click Spring and Rivets | .14   | 24-C     | Handle Knob  | .24   | 37-C     | Pinion Gear (for Model Nos. 109 and 110) | .40   | 47-C     | Yoke Spring                        | .04   |
| 12-C     | Drag Dog                | .10   | 25       | Handle Knob Rivet  | .06   | 38       | Pinion Gear (for Model Nos. 109 and 110) | .40   | 48-C     | Yoke Plate Spring                  | .04   |
| 13       | Drag Dog Spring         | .03   | 26       | Handle Knob Flat Washer                                    | .01   | 38-C     | Pinion Gear (for Model Nos. 209 and 210) | .40   | 49-B     | Yoke Guide Stud                    | .06   |
| 18       | Drag Fiber Washer       | .05   | 28       | Handle Knob Oiler  | .16   | 39       | Pinion Gear Clutch                       | .26   | 50       | Yoke Guide Stud Screw              | .02   |
| 21       | Drag Lock Washer        | .05   | 31       | Left Side Plate Complete with Part Nos. 5-D, 6-D and 7-C   | 1.30  | 42       | Right Side Plate                         | 1.00  | 50-B     | Yoke Plate Screw                   | .02   |
| 10       | Drag Eared Washer       | .04   |          |  |       |          |  |       |          |                                    |       |
| 45       | Drag Star Top Washer    | .50   |          |  |       |          |  |       |          |                                    |       |
| 8        | Drag Star               | .50   |          |  |       |          |  |       |          |                                    |       |
| 9        | Drag Cup                | .70   |          |  |       |          |  |       |          |                                    |       |